

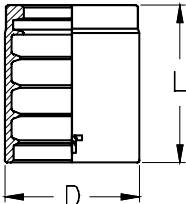
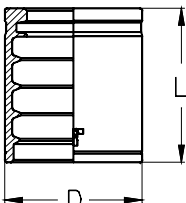
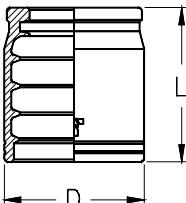

NO SKIVE	HSC	SWAGED NON SKIVE FERRULE BOCCOLA A PRESSARE NON SKIVE										
		TIEFFE Part. N°	Hose I.D. Ø Interno tubo			Dimensions (mm)		Applications Applicazioni				
			DN	SIZE	Inch	D	L					
	HSC04	6	04	1/4"	19	23	1SC					
	HSC05	8	05	5/16"	20	27,5	1SC					
	HSC06	10	06	3/8"	23	30	1SC					
	HSC08	12	08	1/2"	26,5	32	1SC					
	HSC10	16	10	5/8"	29	35	1SC					
	HSC12	19	12	3/4"	33	34	1SC					
	HSC16	25	16	1"	42	45	1SC					

NO SKIVE	HXT1	SWAGED NON SKIVE FERRULE BOCCOLA A PRESSARE NON SKIVE										
		TIEFFE Part. N°	Hose I.D. Ø Interno tubo			Dimensions (mm)		Applications Applicazioni				
			DN	SIZE	Inch	D	L					
	HXT103	5	03	3/16"	19	24	1SN	R1AT				
	HXT104	6	04	1/4"	20	27	1SN	R1AT	2SC			
	HXT105	8	05	5/16"	22	27,5	1SN	R1AT	2SC			
	HXT106	10	06	3/8"	24,5	30	1SN	R1AT	2SC			
	HXT108	12	08	1/2"	28	32,5	1SN	R1AT	2SC			
	HXT110	16	10	5/8"	32	35	1SN	R1AT	2SC			
	HXT112	19	12	3/4"	36	40	1SN	R1AT	2SC			
	HXT116	25	16	1"	45	50	1SN	R1AT	2SC			
	HXT120	31	20	1 1/4"	54	50	1SN	R1AT				
	HXT124	38	24	1 1/2"	62	55	1SN	R1AT				
	HXT132	51	32	2"	76	60	1SN	R1AT				

NO SKIVE	HXT	SWAGED NON SKIVE FERRULE BOCCOLA A PRESSARE NON SKIVE										
		TIEFFE Part. N°	Hose I.D. Ø Interno tubo			Dimensions (mm)		Applications Applicazioni				
			DN	SIZE	Inch	D	L					
	HXT03	5	03	3/16"	20	24	2SN	R2AT				
	HXT04	6	04	1/4"	22	26	2SN	R2AT	1SN	R1AT	2SC	
	HXT05	8	05	5/16"	24	27,5	2SN	R2AT	1SN	R1AT	2SC	
	HXT06	10	06	3/8"	26	30	2SN	R2AT	1SN	R1AT	2SC	
	HXT08	12	08	1/2"	30	32,5	2SN	R2AT	1SN	R1AT	2SC	
	HXT10	16	10	5/8"	34	35	2SN	R2AT	1SN	R1AT	2SC	
	HXT12	19	12	3/4"	38	40	2SN	R2AT	1SN	R1AT	2SC	
	HXT16	25	16	1"	48	50	2SN	R2AT				
	HXT20	31	20	1 1/4"	60	57	2SN	R2AT				
	HXT24	38	24	1 1/2"	67	62	2SN	R2AT				
	HXT32	51	32	2"	80	66	2SN	R2AT				

For SAE100 R16 - SAE100 R17 and other compact braided hoses applications, contact TIEFFE.

Voor toepassing van SAE100 R16-SAE100 R17slang neem contact op met FLEXTUBO







BSP TAPS	AGR-K	BSP TAPER MALE - 60° CONE SEAT BSP TAPS TOELOPENDE BU.DR. - 60° CONUS											
		TIEFFE Part.N.	Hose I.D. Ø interno tubo			Thread Filettatura	Dimensions (mm)					Maximum W.P.	
			DN	Size	Inch	F	H	L	S			bar	PSI
XBT0203	5	03	3/16"	1/8"-28	20	45	12				415	6000	
XBT0403	5	03	3/16"	1/4"-19	25	50	15				415	6000	
XBT0204	6	04	1/4"	1/8"-28	21	49	12				450	6500	
XBT0404	6	04	1/4"	1/4"-19	25	53	15				450	6500	
XBT0604	6	04	1/4"	3/8"-19	26	54	19				450	6500	
XBT0405	8	05	5/16"	1/4"-19	25	53	15				350	5000	
XBT0605	8	05	5/16"	3/8"-19	26	54	19				350	5000	
XBT0406	10	06	3/8"	1/4"-19	26	56	15				450	6500	
XBT0606	10	06	3/8"	3/8"-19	27	57	19				450	6500	
XBT0806	10	06	3/8"	1/2"-14	32	63	22				415	6000	
XBT0608	12	08	1/2"	3/8"-19	28	64	19				415	6000	
XBT0808	12	08	1/2"	1/2"-14	33	66	22				415	6000	
XBT0810	16	10	5/8"	1/2"-14	33	69	22				350	5000	
XBT1210	16	10	5/8"	3/4"-14	35	71	27				350	5000	
XBT1212	20	12	3/4"	3/4"-14	36	77	27				350	5000	
XBT1612	20	12	3/4"	1"-11	41	82	36				280	4000	
XBT1616	25	16	1"	1"-11	43	94	36				280	4000	
XBT2016	25	16	1"	1 1/4"-11	47	98	46				210	3000	
XBT2020	32	20	1 1/4"	1 1/4"-11	48	106	46				210	3000	
XBT2424	40	24	1 1/2"	1 1/2"-11	49	114	50				185	2700	
XBT3223	50	32	2"	2"-11	57	127	65				165	2400	

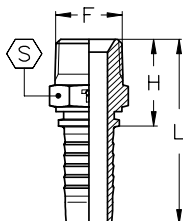

BSP VLAK	AGR FLAT SEAT	BSP PARALLEL MALE - FLAT SEAT BSP PARALLELE BU.DR. - VLAKKE ZITTING											
		TIEFFE Part.N.	Hose I.D. Ø interno tubo			Thread Filettatura	Dimensions (mm)						
			DN	Size	Inch	F	H	L	S				
XBMP0404	6	04	1/4"	1/4"-19	25	53	19						
XBMP0604	6	04	1/4"	3/8"-19	27	55	22						
XBMP0605	8	05	5/16"	3/8"-19	27	55	22						
XBMP0606	10	06	3/8"	3/8"-19	27	58	22						
XBMP0806	10	06	3/8"	1/2"-14	32	62	27						
XBMP0808	12	08	1/2"	1/2"-14	33	66	27						
XBMP1008	12	08	1/2"	5/8"-14	35	68	30						
XBMP1208	12	08	1/2"	3/4"-14	36	69	32						
XBMP1010	16	10	5/8"	5/8"-14	35	71	30						
XBMP1210	16	10	5/8"	3/4"-14	36	72	32						
XBMP1212	20	12	3/4"	3/4"-14	37	77	32						
XBMP1612	20	12	3/4"	1"-11	42	82	41						
XBMP1616	25	16	1"	1"-11	43	94	41						
XBMP2020	32	20	1 1/4"	1 1/4"-11	47	105	50						

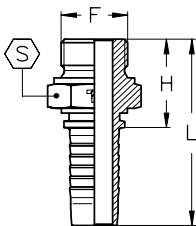



















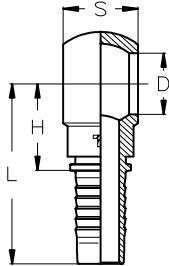

		B.S.P. BANJO BANJOKOPPELING BSP									
TIEFFE Part.N.	Hose I.D. Ø interno tubo			Thread Filettatura	Dimensions (mm)						
	DN	Size	Inch	F	H	L	D	S			
XQB0203	5	03	3/16"	1/8"-28	20	45	10,2	10			
XQB0403	5	03	3/16"	1/4"-19	22,6	47,6	13,3	14			
XQB0204	6	04	1/4"	1/8"-28	23	51	10,2	10			
XQB0404	6	04	1/4"	1/4"-19	23	51	13,3	14			
XQB0604	6	04	1/4"	3/8"-19	26,5	54,5	16,8	17,5			
XQB0804	6	04	1/4"	1/2"-14	33,5	61,5	21	23			
XQB0405	8	05	5/16"	1/4"-19	24	52	13,3	14			
XQB0605	8	05	5/16"	3/8"-19	26,5	54,5	16,8	17,5			
XQB0805	8	05	5/16"	1/2"-14	33,5	61,5	21	23			
XQB0406	10	06	3/8"	1/4"-19	24	54,5	13,3	14			
XQB0606	10	06	3/8"	3/8"-19	24	54,5	16,8	17,5			
XQB0806	10	06	3/8"	1/2"-14	32	62,5	21	23			
XQB0608	12	08	1/2"	3/8"-19	26,5	59,5	16,8	17,5			
XQB0808	12	08	1/2"	1/2"-14	28,5	61,5	21	23			
XQB1008	12	08	1/2"	5/8"-14	31	64	23,1	23,5			
XQB1208	12	08	1/2"	3/4"-14	39	72	26,5	29,5			
XQB0810	16	10	5/8"	1/2"-14	27,2	63	21	23			
XQB1010	16	10	5/8"	5/8"-14	28,2	64	23,1	23,5			
XQB1210	16	10	5/8"	3/4"-14	34,7	70,5	26,5	29,5			
XQB1212	20	12	3/4"	3/4"-14	37,5	78	26,5	29,5			
XQB1612	20	12	3/4"	1"-11	39,5	90,5	33,5	37,5			
XQB1616	25	10	1	1"-11	49	100	33,5	37,5			

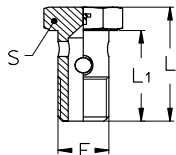

		B.S.P. BANJO BOLT BANJOBOUT BSP					
TIEFFE Part.N.			Thread Filettatura	Dimensions (mm)			
			F	L	L1	S	
QMB02			1/8"-28	26	21,5	14	
QMB04			1/4"-19	34,3	29,5	19	
QMB06			3/8"-19	40,5	34	22	
QMB08			1/2"-14	46	36	27	
QMB10			5/8"-14	55	45,5	30	
QMB12			3/4"-14	56	48	32	
QMB16			1"-11	69	59	41	







AGJ	J.I.C. MALE - 74° CONE SLANGKOPPELING BU.DR. J.I.C. - CONUS 74°											
	TIEFFE Part. N.	Hose I.D. Ø interno tubo			Thread Filetto	Dimensions (mm)						Maximum WP
		DN	Size	Inch	F	H	L	S				bar
XJM0703	5	03	3/16"	7/16"-20	26,3	52	12				415	
XJM0803	5	03	3/16"	1/2"-20	26,3	52	14				415	
XJM0704	6	04	1/4"	7/16"-20	26,5	55	12				450	
XJM0804	6	04	1/4"	1/2"-20	26,5	55	14				450	
XJM0904	6	04	1/4"	9/16"-18	26,5	55	15				450	
XJM0805	8	05	5/16"	1/2"-20	26,5	55	14				350	
XJM0905	8	05	5/16"	9/16"-18	26,5	55	15				350	
XJM1205	8	05	5/16"	3/4"-16	30,2	58,7	19				350	
XJM0906	10	06	3/8"	9/16"-18	26,5	57	15				450	
XJM1206	10	06	3/8"	3/4"-16	30,2	60,5	19				415	
XJM1406	10	06	3/8"	7/8"-14	34,2	64,7	24				350	
XJM1208	12	08	1/2"	3/4"-16	31	64	19				415	
XJM1408	12	08	1/2"	7/8"-14	35,5	68	24				350	
XJM1708	12	08	1/2"	1 1/16"-12	38,5	71,5	27				350	
XJM1410	16	10	5/8"	7/8"-14	35	71	24				350	
XJM1710	16	10	5/8"	1 1/16"-12	38,5	74,5	27				350	
XJM1412	20	12	3/4"	7/8"-14	36	77	27				350	
XJM1712	20	12	3/4"	1 1/16"-12	39,5	80,5	27				350	
XJM1912	20	12	3/4"	1 3/16"-12	41,5	82,5	32				280	
XJM2112	20	12	3/4"	1 5/16"-12	42	83	36				280	
XJM1716	25	16	1"	1 1/16"-12	41	96	32				280	
XJM2116	25	16	1"	1 5/16"-12	42,7	97,7	36				280	
XJM2616	25	16	1"	1 5/8"-12	46	101	46				280	
XJM2620	32	20	1 1/4"	1 5/8"-12	46,5	107,5	46				210	
XJM3020	32	20	1 1/4"	1 7/8"-12	51	112	50				140	
XJM3024	40	24	1 1/2"	1 7/8"-12	51,2	121,7	50				140	
XJM4032	50	32	2"	2 1/2"-12	62,2	138,2	65				105	

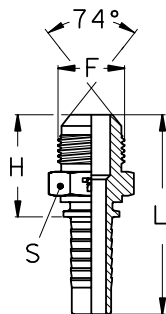

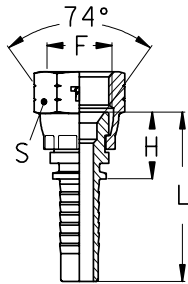

DKJ	J.I.C. FEMALE - 74° CONE SEAT - CRIMPED NUT SLANGKOPPELING WARTEL J.I.C. - CONUS ZITTING 74° - MOER GEPERST											
	TIEFFE Part. N.	Hose I.D. Ø interno tubo			Thread Filetto	Dimensions (mm)						Maximum WP bar
		DN	Size	Inch		F	H	L	S			
XJF0703	5	03	3/16"	7/16"-20		14,5	40,2	15				350
XJF0703SW14	5	03	3/16"	7/16"-20		14,5	40,2	14				350
XJF0803	5	03	3/16"	1/2"-20		16,8	42,5	17				350
XJF0704	6	04	1/4"	7/16"-20		14,7	43,2	15				350
XJF0704SW14	6	04	1/4"	7/16"-20		14,7	43,2	14				350
XJF0804	6	04	1/4"	1/2"-20		16	44,5	17				350
XJF0904	6	04	1/4"	9/16"-18		18	46,5	19				250
XJF0805	8	05	5/16"	1/2"-20		16	44,5	17				350
XJF0905	8	05	5/16"	9/16"-18		17	45,5	19				250
XJF1205	8	05	5/16"	3/4"-16		18,5	47	24				250
XJF1205SW22	8	05	5/16"	3/4"-16		18,5	47	22				250
XJF0906	10	06	3/8"	9/16"-18		17	47,5	19				250
XJF1206	10	06	3/8"	3/4"-16		18,5	49	24				250
XJF1206SW22	10	06	3/8"	3/4"-16		18,5	49	22				250
XJF1406	10	06	3/8"	7/8"-14		19,5	50	27				200
XJF1208	12	08	1/2"	3/4"-16		18,5	51,5	24				250
XJF1208SW22	12	08	1/2"	3/4"-16		18,5	51,5	22				250
XJF1408	12	08	1/2"	7/8"-14		19,5	52,5	27				200
XJF1708	12	08	1/2"	1 1/16"-12		22,5	55,5	32				200
XJF1410	16	10	5/8"	7/8"-14		19,5	55,5	27				200
XJF1710	16	10	5/8"	1 1/16"-12		22,5	58,5	32				200
XJF1412	20	12	3/4"	7/8"-14		20,5	61,5	27				200
XJF1712	20	12	3/4"	1 1/16"-12		22	63	32				200
XJF1912	20	12	3/4"	1 3/16"-12		25,2	66,2	36				160
XJF2112	20	12	3/4"	1 5/16"-12		25,7	66,7	41				160
XJF1716	25	16	1"	1 1/16"-12		23,5	78,5	32				200
XJF2116	25	16	1"	1 5/16"-12		26	81	41				160
XJF2616	25	16	1"	1 5/8"-12		28,8	83,8	50				125
XJF2620	32	20	1 1/4"	1 5/8"-12		27,8	88,8	50				125
XJF3020	32	20	1 1/4"	1 7/8"-12		31	92	55				100
XJF3024	40	24	1 1/2"	1 7/8"-12		31,5	102	55				100
XJF4032	50	32	2"	2 1/2"-12		33,5	109,5	70				80

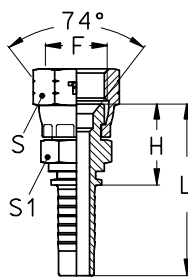

DKJ	JIC STRAIGHT FEMALE - 74° CONE SEAT - DOUBLE EXAGON SLANGKOPPELING WARTEL JIC - CONUS 74° - DUBBELE EXAGON											
	TIEFFE Part. N.	Hose I.D. Ø interno tubo			Thread Filetto	Dimensions (mm)						Maximum WP bar
		DN	Size	Inch		F	H	L	S	S1		
CP0404FIC	6	04	1/4"	7/16"-20		19	47,5	15	12			350
CP0404FIC-EX14	6	04	1/4"	7/16"-20		19	47,5	14	12			350
CP0405FIC	6	04	1/4"	1/2"-20		19	47,5	17	14			350
CP0406FIC	6	04	1/4"	9/16"-18		23	51,5	19	14			250
CP0506FIC	8	05	5/16"	9/16"-18		23	51,5	19	14			250
CP0606FIC	10	06	3/8"	9/16"-18		23	53,4	19	15			250
CP0608FIC	10	06	3/8"	3/4"-16		23,5	54	24	19			250
CP0608FIC-EX22	10	06	3/8"	3/4"-16		23,5	54	22	19			250
CP0808FIC	12	08	1/2"	3/4"-16		24,5	57,5	24	19			250
CP0808FIC-EX22	12	08	1/2"	3/4"-16		24,5	57,5	22	19			250
CP0810FIC	12	08	1/2"	7/8"-14		25,5	58,5	27	22			200
CP1010FIC	16	10	5/8"	7/8"-14		25,5	61,5	27	22			200
CP1012FIC	16	10	5/8"	1 1/16"-12		28	64	32	27			200
CP1212FIC	20	12	3/4"	1 1/16"-12		29	70	32	27			200
CP1616FIC	25	16	1"	1 5/16"-12		35	90	41	32			160

## DKJ90

J.I.C. 90° SWEPT ELBOW - 74° CONE SEAT - ONE PIECE - CRIMPED NUT  
SLANGKOPPELING 90° J.I.C. - CONUS 74° - UIT EEN STUK, MOER GEPERST

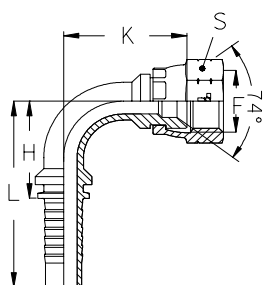

TIEFFE Part. N.	Hose I.D. Ø interno tubo			Thread Filetto	Dimensions (mm)					Maximum WP
	DN	Size	Inch	F	H	L	K	S		bar
XJF900703	5	03	3/16"	7/16"-20	21	47	22	15		350
XJF900703SW14	5	03	3/16"	7/16"-20	21	47	22	14		350
XJF900803	5	03	3/16"	1/2"-20	21	47	23	17		350
XJF900704	6	04	1/4"	7/16"-20	24	52	24	15		350
XJF900704SW14	6	04	1/4"	7/16"-20	24	52	24	14		350
XJF900804	6	04	1/4"	1/2"-20	24	52	25	17		350
XJF900904	6	04	1/4"	9/16"-18	23,5	52	27	19		250
XJF900805	8	05	5/16"	1/2"-20	31	59	29	17		350
XJF900905	8	05	5/16"	9/16"-18	30,5	59	30,5	19		250
XJF901205	8	05	5/16"	3/4"-16	30,5	59	33,5	24		250
XJF901205SW22	8	05	5/16"	3/4"-16	30,5	59	33,5	22		250
XJF900906	10	06	3/8"	9/16"-18	33,5	64	36,5	19		250
XJF901206	10	06	3/8"	3/4"-16	33,5	64	36	24		250
XJF901206SW22	10	06	3/8"	3/4"-16	33,5	64	36	22		250
XJF901406	10	06	3/8"	7/8"-14	33,5	64	38,5	27		200
XJF901208	12	08	1/2"	3/4"-16	41	74	40,5	24		250
XJF901208SW22	12	08	1/2"	3/4"-16	41	74	40,5	22		250
XJF901408	12	08	1/2"	7/8"-14	41	74	42	27		200
XJF901708	12	08	1/2"	1 1/16"-12	41	74	45,5	32		200
XJF901410	16	10	5/8"	7/8"-14	49	85	47	27		200
XJF901710	16	10	5/8"	1 1/16"-12	49	85	50,5	32		200
XJF901412	20	12	3/4"	7/8"-14	58	99	58	27		200
XJF901712	20	12	3/4"	1 1/16"-12	58	99	56,5	32		200
XJF901912	20	12	3/4"	1 3/16"-12	58	99	64	36		160
XJF902112	20	12	3/4"	1 5/16"-12	58	99	65	41		160
XJF901716	25	16	1"	1 1/16"-12	74	129	76	32		200
XJF902116	25	16	1"	1 5/16"-12	74	129	72	41		160
XJF902616	25	16	1"	1 5/8"-12	74	129	77	50		125
XJF902620	32	20	1 1/4"	1 5/8"-12	92	153	87	50		125
XJF903020	32	20	1 1/4"	1 7/8"-12	92	153	91	55		100
XJF903024	40	24	1 1/2"	1 7/8"-12	108	179	100	55		100
XJF904032	50	32	2"	2 1/2"-12	142	218	126	70		80

## DKJ45

J.I.C. 45° SWEPT ELBOW - 74° CONE SEAT - ONE PIECE - CRIMPED NUT  
SLANGKOPPELING 45° J.I.C. - CONUS 74° - UIT EEN STUK, MOER GEPERST

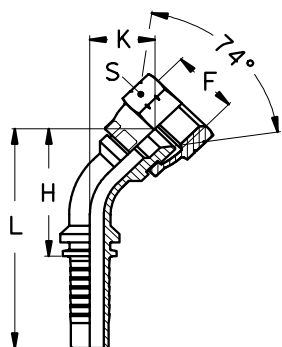

TIEFFE Part. N.	Hose I.D. Ø interno tubo			Thread Filetto	Dimensions (mm)						Maximum WP
	DN	Size	Inch	F	H	L	K	S			bar
XJF450703	5	03	3/16"	7/16"-20	34,5	60,5	13	15			350
XJF450703SW14	5	03	3/16"	7/16"-20	34,5	60,5	13	14			350
XJF450803	5	03	3/16"	1/2"-20	36	62	14,5	17			350
XJF450704	6	04	1/4"	7/16"-20	37	66	13,5	15			350
XJF450704SW14	6	04	1/4"	7/16"-20	37	66	13,5	14			350
XJF450804	6	04	1/4"	1/2"-20	38	67	14,5	17			350
XJF450904	6	04	1/4"	9/16"-18	39,5	68	15,5	19			250
XJF450805	8	05	5/16"	1/2"-20	46	74,5	16	17			350
XJF450905	8	05	5/16"	9/16"-18	47,5	76	17,5	19			250
XJF451205	8	05	5/16"	3/4"-16	49,5	77,5	19	24			250
XJF451205SW22	8	05	5/16"	3/4"-16	49,5	77,5	19	22			250
XJF450906	10	06	3/8"	9/16"-18	53,5	84	19,5	19			250
XJF451206	10	06	3/8"	3/4"-16	53,5	84	19,5	24			250
XJF451206SW22	10	06	3/8"	3/4"-16	53,5	84	19,5	22			250
XJF451406	10	06	3/8"	7/8"-14	55	85,5	21	27			200
XJF451208	12	08	1/2"	3/4"-16	61,5	94,5	22	24			200
XJF451208SW22	12	08	1/2"	3/4"-16	61,5	94,5	22	22			250
XJF451408	12	08	1/2"	7/8"-14	62,5	95,5	23	27			200
XJF451708	12	08	1/2"	1 1/16"-12	65	98	25,5	32			200
XJF451410	16	10	5/8"	7/8"-14	76	112	24	27			200
XJF451710	16	10	5/8"	1 1/16"-12	78,5	114,5	26	32			200
XJF451412	20	12	3/4"	7/8"-14	87	128	33,5	27			200
XJF451712	20	12	3/4"	1 1/16"-12	85,5	126,5	32	32			200
XJF451912	20	12	3/4"	1 3/16"-12	88,5	129,5	35	36			160
XJF452112	20	12	3/4"	1 5/16"-12	91	132	37,5	41			160
XJF451716	25	16	1"	1 1/16"-12	113	167,5	44,5	32			200
XJF452116	25	16	1"	1 5/16"-12	108	162,5	40	41			160
XJF452616	25	16	1"	1 5/8"-12	111	166	43	50			125
XJF452620	32	20	1 1/4"	1 5/8"-12	136	196,5	52	50			125
XJF453020	32	20	1 1/4"	1 7/8"-12	141	201,5	57	55			100
XJF453024	40	2'4	1 1/2"	1 7/8"-12	161	231	57	55			100
XJF454032	50	32	2"	2 1/2"-12	206	281	66,5	70			80

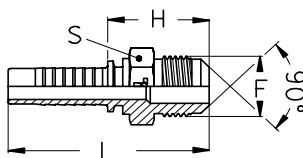
		SAE MALE - 90° CONE SLANGKOPPELING BU.DR. SAE - CONUS 90°									
TIEFFE Part. N.	Hose I.D. Ø interno tubo			Thread Filetto	Dimensions (mm)						
	DN	Size	Inch	F	H	L	S				
											
XMS1005	8	05	5/16"	5/8"-18	28,2	56,7	17				
XMS1006	10	06	3/8"	5/8"-18	28,2	58,7	17				
XMS1712	20	12	3/4"	1 1/16"-14	40,5	81,5	27				

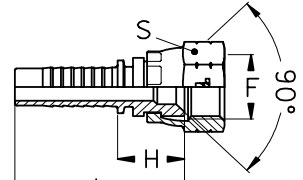
		SAE FEMALE - 90° CONE SEAT - CRIMPED NUT SLANGKOPPELING SAE - CONUS 90° - UIT EEN STUK, MOER GEPERST									
TIEFFE Part. N.	Hose I.D. Ø interno tubo			Thread Filetto	Dimensions (mm)						
	DN	Size	Inch	F	H	L	S				
											
XFS1005	8	05	5/16"	5/8"-18	17,6	46,1	22				
XFS1006	10	06	3/8"	5/8"-18	16,6	47,1	22				
XFS1712	20	12	3/4"	1 1/16"-14	23,2	64,2	32				

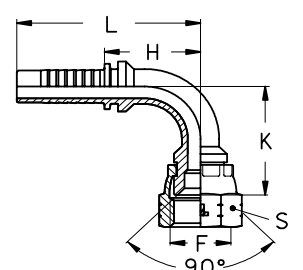
		SAE 90° SWEPT ELBOW - 90° CONE SEAT - ONE PIECE - CRIMPED NUT SLANGKOPPELING 90° SAE - CONUS 90° - UIT EEN STUK, MOER GEPERST									
TIEFFE Part. N.	Hose I.D. Ø interno tubo			Thread Filetto	Dimensions (mm)						
	DN	Size	Inch	F	H	L	K	S			
											
XFS901005	8	05	5/16"	5/8"-18	31	59	30	22			
XFS901006	10	06	3/8"	5/8"-18	34	64	33	22			
XFS901712	20	12	3/4"	1 1/16"-14	58	99	56	32			

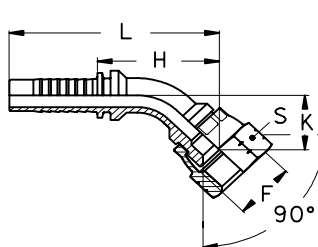
		SAE 45° SWEPT ELBOW - 90° CONE SEAT - ONE PIECE - CRIMPED NUT SLANGKOPPELING 45° SAE - CONUS 90° - UIT EEN STUK, MOER GEPERST									
TIEFFE Part. N.	Hose I.D. Ø interno tubo			Thread Filetto	Dimensions (mm)						
	DN	Size	Inch	F	H	L	K	S			
											
XFS451005	8	05	5/16"	5/8"-18	47	75	18	22			
XFS451006	10	06	3/8"	5/8"-18	50	81	18	22			
XFS451712	20	12	3/4"	1 1/16"-14	85	125	32	32			

## SAE O' RING MALE BU.DR. SLANGKOPPELING SAE MET ORING

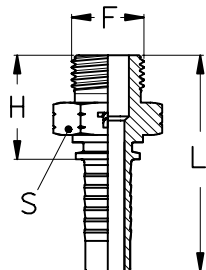

TIEFFE Part. N.	Hose I.D. Ø interno tubo			Thread Filetto	Dimensions (mm)					Maximum WP bar
	DN	Size	Inch		F	H	L	S		
	CP0404MS	6	04	1/4"	7/16"-20	23	51,5	14		
CP0405MS	6	04	1/4"	1/2"-20	23	51,5	17			350
CP0406MS	6	04	1/4"	9/16"-18	24,5	53	17			250
CP0506MS	8	05	5/16"	9/16"-18	24,5	53	17			250
CP0606MS	10	06	3/8"	9/16"-18	24,5	55	17			250
CP0608MS	10	06	3/8"	3/4"-16	26,5	57	24			250
CP0808MS	12	08	1/2"	3/4"-16	27	60	24			250
CP0810MS	12	08	1/2"	7/8"-14	30	63	25			200
CP0812MS	12	08	1/2"	1 1/16"-12	34	67	32			200
CP1010MS	16	10	5/8"	7/8"-14	30	66	25			200
CP1012MS	16	10	5/8"	1 1/16"-12	34	70	32			200
CP1212MS	20	12	3/4"	1 1/16"-12	35	76	32			200
CP1216MS	20	12	3/4"	1 5/16"-12	36	77	38			160
CP1616MS	25	16	1"	1 5/16"-12	37	92	38			160

## ORFS

## ORFS MALE BU.DR. SLANGKOPPELING ORFS

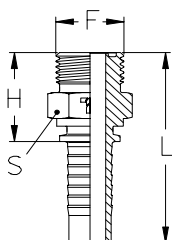

TIEFFE Part. N.	Hose I.D. Ø interno tubo			Thread Filetto	Dimensions (mm)					Maximum WP bar
	DN	Size	Inch		F	H	L	S		
	XMU0904	6	04	1/4"	9/16"-18	23,5	52	17		
XMU1104	6	04	1/4"	11/16"-16	26	54,5	19			450
XMU1105	8	05	5/16"	11/16"-16	26	54,5	19			350
XMU1106	10	06	3/8"	11/16"-16	26	56,5	19			445
XMU1306	10	06	3/8"	13/16"-16	28	58,5	22			445
XMU1606	10	06	3/8"	1"-14	32,5	63	27			445
XMU1308	12	08	1/2"	13/16"-16	29	62	22			415
XMU1608	12	08	1/2"	1"-14	33,5	66,5	27			415
XMU1908	12	08	1/2"	1 3/16"-12	35	68	32			415
XMU1610	16	10	5/8"	1"-14	33,5	69,5	27			350
XMU1910	16	10	5/8"	1 3/16"-12	35	71	32			350
XMU1912	20	12	3/4"	1 3/16"-12	36	77	32			350
XMU2312	20	12	3/4"	1 7/16"-12	36,5	77,5	41			350
XMU2316	25	16	1"	1 7/16"-12	38	93	41			280
XMU2720	32	20	1 1/4"	1 11/16"-12	40	101	46			210
XMU3224	40	24	1 1/2"	2"-12	43	113,5	55			185

TIEFFE Part. N.	ORFS FEMALE - LOOSE NUT SLANGKOPPELING WARTEL ORFS - LOSSE MOER										
	Hose I.D. Ø interno tubo			Thread Filetto	Dimensions (mm)						Maximum WP
	DN	Size	Inch	F	H	L	S				bar
XFU0904	6	04	1/4"	9/16"-18	21	49,5	17				450
XFU1104	6	04	1/4"	11/16"-16	23	51,5	22				450
XFU1105	8	05	5/16"	11/16"-16	23	51,5	22				350
XFU1106	10	06	3/8"	11/16"-16	23	53,5	22				445
XFU1306	10	06	3/8"	13/16"-16	26	56,5	24				445
XFU1308	12	08	1/2"	13/16"-16	26,5	59,5	24				415
XFU1608	12	08	1/2"	1"-14	30	63	30				415
XFU1908	12	08	1/2"	1 3/16"-12	33	66	36				415
XFU1610	16	10	5/8"	1"-14	30	66	30				350
XFU1910	16	10	5/8"	1 3/16"-12	33	69	36				350
XFU1912	20	12	3/4"	1 3/16"-12	33,5	74,5	36				350
XFU2312	20	12	3/4"	1 7/16"-12	34,5	75,5	41				350
XFU2316	25	16	1"	1 7/16"-12	35,5	90,5	41				280
XFU2720	32	20	1 1/4"	1 11/16"-12	36	97	50				210
XFU3224	40	24	1 1/2"	2"-12	36,5	107	60				185

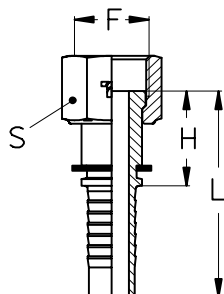

TIEFFE Part. N.	90° ORFS SWEPT ELBOW - ONE PIECE - LOOSE NUT SLANGKOPPELING 90° ORFS - EEN STUK - LOSSE MOER										
	Hose I.D. Ø interno tubo			Thread Filetto	Dimensions (mm)						Maximum WP
	DN	Size	Inch	F	H	L	K	S			bar
XFU900904	6	04	1/4"	9/16"-18	24	52	21	17			450
XFU901104	6	04	1/4"	11/16"-16	24	52	24	22			450
XFU901105	8	05	5/16"	11/16"-16	31	59	26,5	22			350
XFU901106	10	06	3/8"	11/16"-16	34	64	29,5	22			445
XFU901306	10	06	3/8"	13/16"-16	34	64	32,5	24			445
XFU901308	12	08	1/2"	13/16"-16	41	74	35,5	24			415
XFU901608	12	08	1/2"	1"-14	41	74	39	30			415
XFU901908	12	08	1/2"	1 3/16"-12	41	74	42	36			415
XFU901610	16	10	5/8"	1"-14	49	85	43,5	30			350
XFU901910	16	10	5/8"	1 3/16"-12	49	85	46,5	36			350
XFU901912	20	12	3/4"	1 3/16"-12	58	99	52	36			350
XFU902312	20	12	3/4"	1 7/16"-12	58	99	56	41			350
XFU902316	25	16	1"	1 7/16"-12	74	129	61,5	41			280
XFU902720	32	20	1 1/4"	1 11/16"-12	92	153	73,5	50			210
XFU903224	40	24	1 1/2"	2"-12	108	179	82,5	60			185

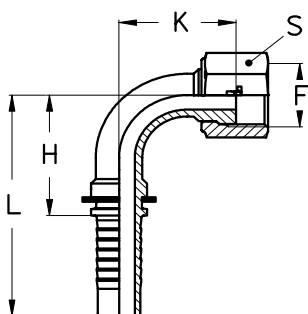

## ORFS45

### 45° ORFS SWEPT ELBOW - ONE PIECE - LOOSE NUT SLANGKOPPELING 45° ORFS - EEN STUK - LOSSE MOER

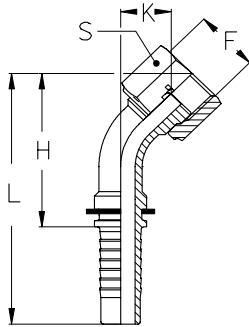

TIEFFE Part. N.	Hose I.D. Ø interno tubo			Thread Filetto	Dimensions (mm)					Maximum WP bar
	DN	Size	Inch	F	H	L	K	S		
XFU450904	6	04	1/4"	9/16"-18	35,5	64	11,5	17		450
XFU451104	6	04	1/4"	11/16"-16	37	65,5	13	22		450
XFU451105	8	05	5/16"	11/16"-16	44,5	73	14	22		350
XFU451106	10	06	3/8"	11/16"-16	48,5	79	14,5	22		445
XFU451306	10	06	3/8"	13/16"-16	51	81,5	17	24		445
XFU451308	12	08	1/2"	13/16"-16	58	91	18,5	24		415
XFU451608	12	08	1/2"	1"-14	60	93	21	30		415
XFU451908	12	08	1/2"	1 3/16"-12	62,5	95,5	23	36		415
XFU451610	16	10	5/8"	1"-14	73,5	109,5	21	30		350
XFU451910	16	10	5/8"	1 3/16"-12	75,7	111,5	23,5	36		350
XFU451912	20	12	3/4"	1 3/16"-12	82,5	123,5	29	36		350
XFU452312	20	12	3/4"	1 7/16"-12	85,5	126,5	32	41		350
XFU452316	25	16	1"	1 7/16"-12	103	157,5	34,5	41		280
XFU452720	32	20	1 1/4"	1 11/16"-12	127	187,5	43	50		210
XFU453224	40	24	1 1/2"	2"-12	141	219,5	45	60		185



## AGM

### METRIC MALE - 60° CONE SEAT SLANGKOPPELING BU.DR. METRISCH - CONUS 60°

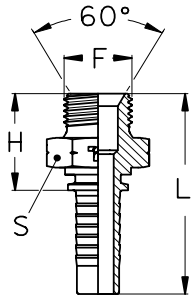

TIEFFE Part. N.	Hose I.D. Ø interno tubo			Thread Filetto	Dimensions (mm)						
	DN	Size	Inch	F	H	L	S				
XM61003	5	03	3/16"	M10x1	19	45	14				
XM61203	5	03	3/16"	M12x1,5	24	49	17				
XM61004	6	04	1/4"	M10x1	20	48	14				
XM61204	6	04	1/4"	M12x1,5	24	52	17				
XM61404	6	04	1/4"	M14x1,5	25	53	19				
XM61604	6	04	1/4"	M16x1,5	26	54	22				
XM61804	6	04	1/4"	M18x1,5	27	55	24				
XM61405	8	05	5/16"	M14x1,5	25	53	19				
XM61605	8	05	5/16"	M16x1,5	26	54	22				
XM61805	8	05	5/16"	M18x1,5	27	55	24				
XM61406	10	06	3/8"	M14x1,5	25	55	19				
XM61606	10	06	3/8"	M16x1,5	26	56	22				
XM61806	10	06	3/8"	M18x1,5	27	57	24				
XM62006	10	06	3/8"	M20x1,5	29	59	25				
XM62206	10	06	3/8"	M22x1,5	29	59	27				
XM61808	12	08	1/2"	M18x1,5	28	60	24				
XM62008	12	08	1/2"	M20x1,5	29	62	25				
XM62208	12	08	1/2"	M22x1,5	29	62	27				
XM62408	12	08	1/2"	M24x1,5	30	63	30				
XM62608	12	08	1/2"	M26x1,5	33	66	32				
XM62610	16	10	5/8"	M26x1,5	32	68	32				
XM62612	20	12	3/4"	M26x1,5	33	74	32				
XM63012	20	12	3/4"	M30x1,5	34	75	36				
XM63816	25	16	1"	M38x1,5	37	92	46				
XM64520	32	20	1 1/4"	M45x1,5	38	99	50				

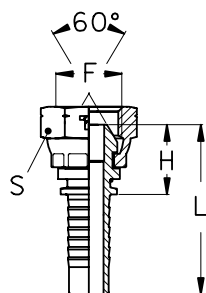

TIEFFE Part. N.	Hose I.D. Ø interno tubo		Thread Filetto	F	Dimensions (mm)			
	DN	Size			H	L	S	
	<b>DKM</b>	<b>METRIC FEMALE - 60° CONE - CRIMPED NUT SLANGKOPPELING METRISCH - CONUS 60° - GEPERSTE MOER</b>						
XF61003	5	4,8	3/16"	M10x1	19	44	14	
XF61203	5	4,8	3/16"	M12x1,5	19	44	15	
XF61004	6	6,3	1/4"	M10X1	19	47	14	
XF61204	6	6,3	1/4"	M12x1,5	19	47	15	
XF61404	6	6,3	1/4"	M14x1,5	18	47	17	
XF61604	6	6,3	1/4"	M16x1,5	20	49	22	
XF61804	6	6,3	1/4"	M18x1,5	20	49	22	
XF61405	8	7,9	5/16"	M14x1,5	18	47	17	
XF61605	8	7,9	5/16"	M16x1,5	20	49	22	
XF61805	8	7,9	5/16"	M18x1,5	20	49	22	
XF61406	10	9,5	3/8"	M14x1,5	18	49	17	
XF61606	10	9,5	3/8"	M16x1,5	20	51	22	
XF61806	10	9,5	3/8"	M18x1,5	20	51	22	
XF62006	10	9,5	3/8"	M20x1,5	22	53	27	
XF62206	10	9,5	3/8"	M22x1,5	22	53	27	
XF61808	12	12,7	1/2"	M18x1,5	21	54	22	
XF62008	12	12,7	1/2"	M20x1,5	23	56	27	
XF62208	12	12,7	1/2"	M22x1,5	23	56	27	
XF62408	12	12,7	1/2"	M24x1,5	23	56	30	
XF62608	12	12,7	1/2"	M26x1,5	25	58	32	
XF62610	16	15,9	5/8"	M26x1,5	25	61	32	
XF62612	20	19,1	3/4"	M26x1,5	26	67	32	
XF63012	20	19,1	3/4"	M30x1,5	26	67	36	
XF63816	25	25,4	1"	M38x1,5	30	85	46	
XF64520	32	31,8	1 1/4"	M45x1,5	34	95	50	

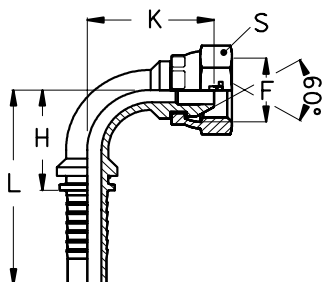

TIEFFE Part. N.	Hose I.D. Ø interno tubo		Thread Filetto	F	Dimensions (mm)			
	DN	Size			H	L	K	S
	<b>DKM90</b>	<b>METRIC 90° SWEPT ELBOW - 60° CONE - ONE PIECE - CRIMPED NUT SLANGKOPPELING 90° METRISCH - CONUS 60° - 1 STUK - GEPERSTE MOER</b>						
XF6901003	5	4,8	3/16"	M10x1	21	47	25	14
XF6901203	5	4,8	3/16"	M12x1,5	21	47	28	15
XF6901004	6	6,3	1/4"	M10X1	24	52	16	14
XF6901204	6	6,3	1/4"	M12x1,5	24	52	28	15
XF6901404	6	6,3	1/4"	M14x1,5	24	52	28	17
XF6901604	6	6,3	1/4"	M16x1,5	24	52	31	22
XF6901804	6	6,3	1/4"	M18x1,5	24	52	31	22
XF6901405	8	7,9	5/16"	M14x1,5	31	59	31,5	17
XF6901605	8	7,9	5/16"	M16x1,5	31	59	33,5	22
XF6901805	8	7,9	5/16"	M18x1,5	31	59	33,5	22
XF6901406	10	9,5	3/8"	M14x1,5	34	64	35,5	17
XF6901606	10	9,5	3/8"	M16x1,5	34	64	40,5	22
XF6901806	10	9,5	3/8"	M18x1,5	34	64	40,5	22
XF6902006	10	9,5	3/8"	M20x1,5	34	64	40,5	27
XF6902206	10	9,5	3/8"	M22x1,5	34	64	40,5	27
XF6901808	12	12,7	1/2"	M18x1,5	41	74	42	22
XF6902008	12	12,7	1/2"	M20x1,5	41	74	44	27
XF6902208	12	12,7	1/2"	M22x1,5	41	74	44	27
XF6902408	12	12,7	1/2"	M24x1,5	41	74	45,5	30
XF6902608	12	12,7	1/2"	M26x1,5	41	74	49,5	32
XF6902610	16	15,9	5/8"	M26x1,5	49	85	54,5	32
XF6902612	20	19,1	3/4"	M26x1,5	58	99	60,5	32
XF6903012	20	19,1	3/4"	M30x1,5	58	99	65	36
XF6903816	25	25,4	1"	M38x1,5	74	129	79	46
XF6904520	32	31,8	1 1/4"	M45x1,5	92	179	89	50

## DKM45

METRIC 45° SWEEP ELBOW - 60° CONE - ONE PIECE - CRIMPED NUT  
SLANGKOPPELING 45° METRISCH - CONUS 60° - 1 STUK - MOER GEPERST

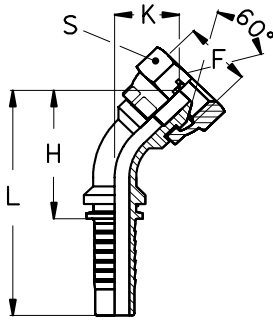

TIEFFE Part. N.	Hose I.D. Ø interno tubo			Thread Filetto	Dimensions (mm)				Maximum WP bar
	DN	Size	Inch	F	H	L	K	S	
XF6451003	5	4,8	3/16"	M10x1	36	61,5	14	14	
XF6451203	5	4,8	3/16"	M12x1,5	37,5	63	15,5	15	
XF6451004	6	6,3	1/4"	M10x1	39	67,5	15	14	
XF6451204	6	6,3	1/4"	M12x1,5	40	68,5	16,5	15	
XF6451404	6	6,3	1/4"	M14x1,5	40	68,5	16,5	17	
XF6451604	6	6,3	1/4"	M16x1,5	42,5	71	18,5	22	
XF6451804	6	6,3	1/4"	M18x1,5	42,5	71	18,5	22	
XF6451405	8	7,9	5/16"	M14x1,5	48	76,5	18	17	
XF6451605	8	7,9	5/16"	M16x1,5	49,5	78	19,5	22	
XF6451805	8	7,9	5/16"	M18x1,5	49,5	78	19,5	22	
XF6451406	10	9,5	3/8"	M14x1,5	53	83,5	19	17	
XF6451606	10	9,5	3/8"	M16x1,5	53,5	84	19,5	22	
XF6451806	10	9,5	3/8"	M18x1,5	53,5	84	19,5	22	
XF6452006	10	9,5	3/8"	M20x1,5	56,5	87	22,5	27	
XF6452206	10	9,5	3/8"	M22x1,5	56,5	87	22,5	27	
XF6451808	12	12,7	1/2"	M18x1,5	62,5	95,5	23	22	
XF6452008	12	12,7	1/2"	M20x1,5	64	97	24,5	27	
XF6452208	12	12,7	1/2"	M22x1,5	64	97	24,5	27	
XF6452408	12	12,7	1/2"	M24x1,5	65	98	25,5	30	
XF6452608	12	12,7	1/2"	M26x1,5	67,5	101	28	32	
XF6452610	16	15,9	5/8"	M26x1,5	81	117	29	32	
XF6452612	20	19,1	3/4"	M26x1,5	88,5	130	35	32	
XF6453012	20	19,1	3/4"	M30x1,5	91	132	38,5	36	
XF6453816	25	25,4	1"	M38x1,5	114	169	46	46	
XF6454520	32	31,8	1 1/4"	M45x1,5	138	199	54	50	

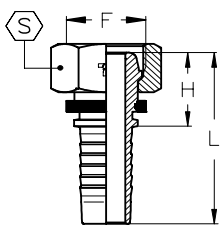
DIN 20078/3868	DKL	METRIC FEMALE - MULTISEAL METRISCH WARTEL - MULISEAL												
		TIEFFE Part.N.	Hose I.D. Ø interno tubo			Thread Filettatura	Tube	Dimensions (mm)				Maximum W.P.		
			DN	Size	Inch	F	mm	H	L	S		bar	PSI	
		<b>XFE140804</b>	6	04	1/4"	M14x1,5	8	20	48	17			280	4000
		<b>XFE161004</b>	8	05	5/16"	M16x1,5	10	20	48	19			280	4000
		<b>XFE181206</b>	10	06	3/8"	M18x1,5	12	20	50	22			280	4000
		<b>XFE221508</b>	12	08	1/2"	M22x1,5	15	21	54	27			280	4000
		<b>XFE261810</b>	16	10	5/8"	M26x1,5	18	23	58	32			210	3000

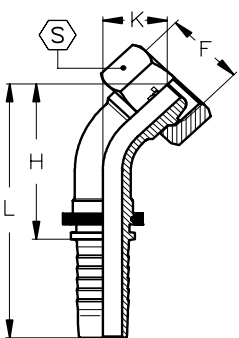
DIN 20078/3868	DKL45	45° METRIC SWEPT ELBOW - MULTISEAL SLANGKOPPELING BOCHT 45° METRISCH - MULTISEAL												
		TIEFFE Part.N.	Hose I.D. Ø interno tubo			Thread Filettatura	Tube	Dimensions (mm)				Maximum W.P.		
			DN	Size	Inch	F	mm	H	L	K	S	bar	PSI	
		<b>XFE45140804</b>	6	04	1/4"	M14x1,5	8	35	63	13	17		280	4000
		<b>XFE45161005</b>	8	05	5/16"	M16x1,5	10	37	65	15	19		280	4000
		<b>XFE45181206</b>	10	06	3/8"	M18x1,5	12	39	69	15	22		280	4000
		<b>XFE45221508</b>	12	08	1/2"	M22x1,5	15	45	78	17	27		280	4000
		<b>XFE45261810</b>	16	10	5/8"	M26x1,5	18	52	87	20	32		210	3000

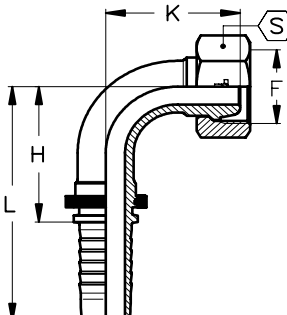
DIN 20078/3868	DKL90	90° METRIC SWEPT ELBOW - MULTISEAL SLANGKOPPELING 90° METRISCH - MULTISEAL												
		TIEFFE Part.N.	Hose I.D. Ø interno tubo			Thread Filettatura	Tube	Dimensions (mm)				Maximum W.P.		
			DN	Size	Inch	F	mm	H	L	K	S	bar	PSI	
		<b>XFE90140804</b>	6	04	1/4"	M14x1,5	8	29	57	27	17		280	4000
		<b>XFE90161005</b>	8	05	5/16"	M16x1,5	10	31	59	30	19		280	4000
		<b>XFE90181206</b>	10	06	3/8"	M18x1,5	12	31	61	30	22		280	4000
		<b>XFE90221508</b>	12	08	1/2"	M22x1,5	15	37	70	36	27		280	4000
		<b>XFE90261810</b>	16	10	5/8"	M26x1,5	18	45	81	42	32		210	3000

## METRIC BANJO - ONEPIECE METRISCHE BANJO - UIT 1 DEEL

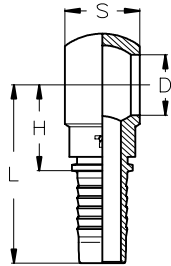

TIEFFE Part.N.	Hose I.D. Ø interno tubo			Thread Filettatura	Dimensions (mm)				
	DN	Size	Inch	F	H	L	D	S	
XQB0203	5	03	3/16"	M10x1	20	45	10,2	10	
XQE1203	5	03	3/16"	M12x1,5	21,1	46,1	12,1	12	
XQE1403	5	03	3/16"	M14x1,5	22,6	47,6	14,2	14	
XQB0204	6	04	1/4"	M10x1	23	51	10,2	10	
XQE1204	6	04	1/4"	M12x1,5	23	51	12,1	12	
XQE1404	6	04	1/4"	M14x1,5	23	51	14	14	
XQE1604	6	04	1/4"	M16x1,5	26,5	54,5	16,2	17,5	
XQE1804	6	04	1/4"	M18x1,5	28,5	56,5	18,2	20,5	
XQE1205	8	05	5/16"	M12x1,5	23,5	51,5	12,1	12	
XQE1405	8	05	5/16"	M14x1,5	24	52	14,2	14	
XQE1605	8	05	5/16"	M16x1,5	26,5	54,5	16,2	17,5	
XQE1805	8	05	5/16"	M18x1,5	28,5	56,5	18,2	20,5	
XQE1406	10	06	3/8"	M14x1,5	24	54,5	14,2	14	
XQE1606	10	06	3/8"	M16x1,5	24	54,5	16,2	17,5	
XQE1806	10	06	3/8"	M18x1,5	27	57,5	18,2	20,5	
XQE2006	10	06	3/8"	M20x1,5	32	62,5	20,2	23	
XQE2206	10	06	3/8"	M22x1,5	32	62,5	22,2	22,5	
XQB1208	12	08	1/2"	M26x1,5	39	72	26,5	29,5	
XQE1808	12	08	1/2"	M18x1,5	28,1	61,1	18,2	20,5	
XQE2008	12	08	1/2"	M20x1,5	28,5	61,5	20,2	23	
XQE2208	12	08	1/2"	M22x1,5	28,5	61,5	22,2	22,5	
XQB1210	16	10	5/8"	M26x1,5	34,7	70,5	26,5	29,5	
XQE2210	16	10	5/8"	M22x1,5	27,2	63	22,2	22,5	
XQB1212	20	12	3/4"	M26x1,5	37,5	78	26,5	29,5	
XQE3012	20	12	3/4"	M30x1,5	41,5	82	30,2	30	
XQE3016	25	16	1"	M30x1,5	43	94	30,2	37	

## METRIC BANJO BOLT METRISCHE BANJO BOUT

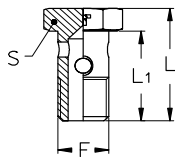

TIEFFE Part.N.	Thread Filettatura	Dimensions (mm)		
		L	L1	S
QME10	M10x1	26	21,5	14
QME12	M12x1,5	31	25,5	17
QME14	M14x1,5	37,5	30,5	19
QME16	M16x1,5	40	32,5	22
QME18	M18x1,5	44	36,5	24
QME20	M20x1,5	48	39,5	27
QME22	M22x1,5	50	41,5	28
QME26	M26x1,5	58	48,5	32
QME30	M30x1,5	64	53	36

ISO 12151-2  
DIN 20078

**CEL**

**METRIC MALE - 24° CONE SEAT - LIGHT DUTY**  
METRISCHE BU.DR. KOPPELING - 24° CONUS - LICHTE SERIE

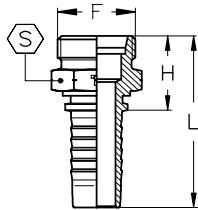

TIEFFE Part.N.	Hose I.D. Ø interno tubo			Thread Filettatura	Tube	Dimensions (mm)				Maximum W.P.		
	DN	Size	Inch	F	mm	H	L	S			bar	PSI
	XME120603	5	03	3/16"	M12x1,5	6	21	46	12			280
XME140803	5	03	3/16"	M14x1,5	8	21	46	14			280	4000
XME120604	6	04	1/4"	M12x1,5	6	21	49	12			280	4000
XME140804	6	04	1/4"	M14x1,5	8	21	49	14			280	4000
XME161004	6	04	1/4"	M16x1,5	10	23	51	17			280	4000
XME181204	6	04	1/4"	M18x1,5	12	23	51	19			280	4000
XME161005	8	05	5/16"	M16x1,5	10	23	51	17			280	4000
XME181205	8	05	5/16"	M18x1,5	12	23	51	19			280	4000
XME161006	10	06	3/8"	M16x1,5	10	23	53	17			280	4000
XME181206	10	06	3/8"	M18x1,5	12	23	53	19			280	4000
XME221506	10	06	3/8"	M22x1,5	15	25	56	22			280	4000
XME221508	12	08	1/2"	M22x1,5	15	26	59	22			280	4000
XME261808	12	08	1/2"	M26x1,5	18	28	61	27			210	3000
XME261810	16	10	5/8"	M26x1,5	18	28	64	27			210	3000
XME302210	16	10	5/8"	M30x2	22	30	66	30			210	3000
XME261812	20	12	3/4"	M26x1,5	18	29	70	27			210	3000
XME302212	20	12	3/4"	M30x2	22	31	72	30			210	3000
XME362816	25	16	1"	M36x2	28	35	86	36			165	2350
XME453520	32	20	1 1/4"	M45x2	35	40	97	46			125	1800
XME524224	40	24	1 1/2"	M52x2	42	42	106	55			100	1450

ISO 12151-2  
DIN 20078

**CES**

**METRIC MALE - 24° CONE SEAT - HEAVY DUTY**  
METRISCHE BU.DR. KOPPELING - 24° CONUS - ZWARE SERIE

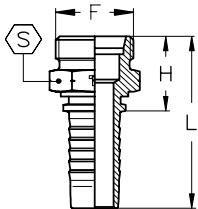

TIEFFE Part.N.	Hose I.D. Ø interno tubo			Thread Filettatura	Tube	Dimensions (mm)				Maximum W.P.		
	DN	Size	Inch	F	mm	H	L	S			bar	PSI
	XME140603	5	03	3/16"	M14x1,5	6	23	48	14			420
XME160803	5	03	3/16"	M16x1,5	8	23	48	17			420	6000
XME140604	6	04	1/4"	M14x1,5	6	23	51	14			450	6500
XME160804	6	04	1/4"	M16x1,5	8	23	51	17			450	6500
XME181004	6	04	1/4"	M18x1,5	10	24	52	19			450	6500
XME201204	6	04	1/4"	M20x1,5	12	25	53	22			450	6500
XME181005	8	05	5/16"	M18x1,5	10	24	52	19			350	5000
XME201205	8	05	5/16"	M20x1,5	12	25	53	22			350	5000
XME181006	10	06	3/8"	M18x1,5	10	24	55	19			450	6500
XME201206	10	06	3/8"	M20x1,5	12	25	56	22			450	6500
XME221406	10	06	3/8"	M22x1,5	14	27	58	22			450	6500
XME221408	12	08	1/2"	M22x1,5	14	28	61	22			420	6000
XME241608	12	08	1/2"	M24x1,5	16	29	62	24			420	6000
XME302010	16	10	5/8"	M30x2	20	32	68	30			350	5000
XME302012	20	12	3/4"	M30x2	20	33	74	30			350	5000
XME362512	20	12	3/4"	M36x2	25	37	78	36			350	5000
XME362516	25	16	1"	M36x2	25	39	90	36			280	4000
XME423016	25	16	1"	M42x2	30	43	94	46			280	4000
XME423020	32	20	1 1/4"	M42x2	30	44	101	46			210	3000
XME523820	32	20	1 1/4"	M52x2	38	48	105	55			210	3000
XME523824	40	24	1 1/2"	M52x2	38	48	112	55			185	2600

ISO 12151-2 DIN 20078	DKOL	METRIC FEMALE - 24° O'RING CONE - LIGHT DUTY METRISCHE WARTELKOPPELING - CONUS 24° O'RING - LICHTE SERIE												
		TIEFFE Part.N.	Hose I.D. Ø interno tubo			Thread Filettatura	Tube	Dimensions (mm)					Maximum W.P.	
			DN	Size	Inch	F	mm	H	L	S	O'Ring	bar	PSI	
	XFEO120603	5	03	3/16"	M12x1,5	6	21	46	14		5x1	280	4000	
	XFEO140803	5	03	3/16"	M14x1,5	8	21	46	17		6x1,5	280	4000	
	XFEO120604	6	04	1/4"	M12x1,5	6	23	51	17		5x1	280	4000	
	XFEO140804	6	04	1/4"	M14x1,5	8	22	50	17		6x1,5	280	4000	
	XFEO161004	6	04	1/4"	M16x1,5	10	24	52	19		7,5x1,5	280	4000	
	XFEO181204	6	04	1/4"	M18x1,5	12	24	52	22		9x1,5	280	4000	
	XFEO161005	8	05	5/16"	M16x1,5	10	24	52	19		7,5x1,5	280	4000	
	XFEO181205	8	05	5/16"	M18x1,5	12	24	52	22		9x1,5	280	4000	
	XFEO161006	10	06	3/8"	M16x1,5	10	23	54	19		7,5x1,5	280	4000	
	XFEO181206	10	06	3/8"	M18x1,5	12	24	54	22		9x1,5	280	4000	
	XFEO221506	10	06	3/8"	M22x1,5	15	24	54	27		12x2	280	4000	
	XFEO221508	12	08	1/2"	M22x1,5	15	24	57	27		12x2	280	4000	
	XFEO261808	12	08	1/2"	M26x1,5	18	26	59	32		15x2	210	3000	
	XFEO261810	16	10	5/8"	M26x1,5	18	27	62	32		15x2	210	3000	
	XFEO302210	16	10	5/8"	M30x2	22	28	64	36		20x2	210	3000	
	XFEO261812	20	12	3/4"	M26x1,5	18	34	75	32		15x2	210	3000	
	XFEO302212	20	12	3/4"	M30x2	22	31	71	36		20x2	210	3000	
	XFEO362816	25	16	1"	M36x2	28	32	83	41		26x2	165	2350	
	XFEO453520	32	20	1 1/4"	M45x2	35	36	94	50		32x2,5	125	1800	
	XFEO524224	40	24	1 1/2"	M52x2	42	37	102	60		38x2,5	100	1450	

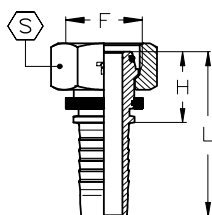

\* Swaged nut

\*\* Tieffe nut

ISO 12151-2 DIN 20078	DKOS	METRIC FEMALE - 24° O'RING CONE - HEAVY DUTY METRISCHE WARTELKOPPELING - CONUS 24° O'RING - ZWARE SERIE												
		TIEFFE Part.N.	Hose I.D. Ø interno tubo			Thread Filettatura	Tube	Dimensions (mm)					Maximum W.P.	
			DN	Size	Inch	F	mm	H	L	S	O'Ring	bar	PSI	
	XFEO140603	5	03	3/16"	M14x1,5	6	21	46	17		5x1	420	6000	
	XFEO160803	5	03	3/16"	M16x1,5	8	21	46	19		6x1,5	420	6000	
	XFEO140604	6	04	1/4"	M14x1,5	6	23	51	17		5x1	450	6500	
	XFEO160804	6	04	1/4"	M16x1,5	8	22	50	19		6x1,5	450	6500	
	XFEO181004	6	04	1/4"	M18x1,5	10	24	52	22		7,5x1,5	450	6500	
	XFEO201204	6	04	1/4"	M20x1,5	12	24	52	24		9x1,5	450	6500	
	XFEO181005	8	05	5/16"	M18x1,5	10	24	52	22		7,5x1,5	350	5000	
	XFEO201205	8	05	5/16"	M20x1,5	12	24	52	24		9x1,5	350	5000	
	XFEO181006	10	06	3/8"	M18x1,5	10	25	55	22		7,5x1,5	450	6500	
	XFEO201206	10	06	3/8"	M20x1,5	12	24	54	24		9x1,5	450	6500	
	XFEO221406	10	06	3/8"	M22x1,5	14	28	58	27		10x2	450	6500	
	XFEO221408	12	08	1/2"	M22x1,5	14	28	61	27		10x2	420	6000	
	XFEO241608	12	08	1/2"	M24x1,5	16	29	62	30		12x2	420	6000	
	XFEO302010	16	10	5/8"	M30x2	20	33	69	36		16,3x2,4	350	5000	
	XFEO302012	20	12	3/4"	M30x2	20	36	76	36		16,3x2,4	350	5000	
	XFEO362512	20	12	3/4"	M36x2	25	38	78	46		20,3x2,4	350	5000	
	XFEO362512SW41	20	12	3/4"	M36x2	25	38	78	41		20,3x2,4	350	5000	
	XFEO362516	25	16	1"	M36x2	25	40	91	46		22x2	280	4000	
	XFEO423016	25	16	1"	M42x2	30	40	91	50		25,3x2,4	280	4000	
	XFEO423020	32	20	1 1/4"	M42x2	30	41	99	50		25,3x2,4	210	3000	
	XFEO523820	32	20	1 1/4"	M52x2	38	45	103	60		33,3x2,4	210	3000	
	XFEO523824	40	24	1 1/2"	M52x2	38	46	110	60		33,3x2,4	185	2600	

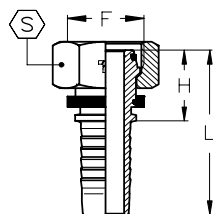

\* Swaged nut



ISO 12151-2 DIN 20078	DKOL45	45° METRIC SWEPT ELBOW - 24° O-RING CONE - LIGHT DUTY METRISCHE BOCHT 45° - 24° CONUS MET ORING - LICHTE SERIE												
		TIEFFE Part.N.	Hose I.D. Ø interno tubo			Thread Filettatura	Tube	Dimensions (mm)					Maximum W.P.	
			DN	Size	Inch	F	mm	H	L	K	S	O'Ring	bar	PSI
	XFEO45120603	5	03	3/16"	M12x1,5	6	34	59	14	14	5x1	280	4000	
	XFEO45140803	5	03	3/16"	M14x1,5	8	35	60	14	17	6x1,5	280	4000	
	XFEO45120604	6	04	1/4"	M12x1,5	6	35	63	14	17	5x1	280	4000	
	XFEO45140804	6	04	1/4"	M14x1,5	8	36	64	14	17	6x1,5	280	4000	
	XFEO45161004	6	04	1/4"	M16x1,5	10	38	66	16	19	7,5x1,5	280	4000	
	XFEO45181204	6	04	1/4"	M18x1,5	12	39	67	17	22	9x1,5	280	4000	
	XFEO45161005	8	05	5/16"	M16x1,5	10	39	67	17	19	7,5x1,5	280	4000	
	XFEO45181205	8	05	5/16"	M18x1,5	12	39	67	18	22	9x1,5	280	4000	
	XFEO45161005	10	06	3/8"	M16x1,5	10	39	69	16	19	7,5x1,5	280	4000	
	XFEO45181206	10	06	3/8"	M18x1,5	12	40	71	18	22	9x1,5	280	4000	
	XFEO45221506	10	06	3/8"	M22x1,5	15	42	72	19	27	12x2	280	4000	
	XFEO45221508	12	08	1/2"	M22x1,5	15	46	79	19	27	12x2	280	4000	
	XFEO45261808	12	08	1/2"	M26x1,5	18	47	80	21	32	15x2	210	3000	
	XFEO45261810	16	10	5/8"	M26x1,5	18	53	89	22	32	15x2	210	3000	
	XFEO45302210	16	10	5/8"	M30x2	22	54	90	23	36	20x2	210	3000	
	XFEO45261812	20	12	3/4"	M26x1,5	18	66	107	29	32	15x2	210	3000	
	XFEO45302212	20	12	3/4"	M30x2	22	62	103	25	36	20x2	210	3000	
	XFEO45362816	25	16	1"	M36x2	28	80	131	31	41	26x2	165	2350	
	XFEO45453520	32	20	1 1/4"	M45x2	35	96	154	40	50	32x2,5	125	1800	
	XFEO45524224	40	24	1 1/2"	M52x2	42	115	179	48	60	38x2,5	100	1450	

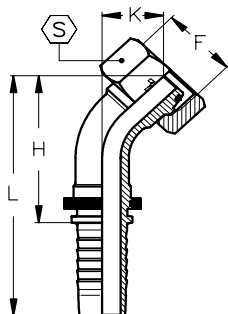

\* Swaged nut

\*\* Tieffe nut

ISO 12151-2 DIN 20078	DKOS45	45° METRIC SWEPT ELBOW - 24° O-RING CONE - HEAVY DUTY METRISCHE BOCHT 45° - 24° CONUS MET ORING - ZWARE SERIE												
		TIEFFE Part.N.	Hose I.D. Ø interno tubo			Thread Filettatura	Tube	Dimensions (mm)					Maximum W.P.	
			DN	Size	Inch	F	mm	H	L	K	S	O'Ring	bar	PSI
	XFEO45140603	5	03	3/16"	M14x1,5	6	34	59	14	17	5x1	420	6000	
	XFEO45160803	5	03	3/16"	M16x1,5	8	35	60	14	19	6x1,5	420	6000	
	XFEO45140604	6	04	1/4"	M14x1,5	6	35	63	14	17	5x1	450	6500	
	XFEO45160804	6	04	1/4"	M16x1,5	8	36	64	14	19	6x1,5	450	6500	
	XFEO45181004	6	04	1/4"	M18x1,5	10	38	66	16	22	7,5x1,5	450	6500	
	XFEO45201204	6	04	1/4"	M20x1,5	12	39	67	17	24	9x1,5	450	6500	
	XFEO45181005	8	05	5/16"	M18x1,5	10	39	67	17	22	7,5x1,5	350	5000	
	XFEO45201205	8	05	5/16"	M20x1,5	12	39	67	18	24	9x1,5	350	5000	
	XFEO45181006	10	06	3/8"	M18x1,5	10	40	70	17	22	7,5x1,5	450	6500	
	XFEO45201206	10	06	3/8"	M20x1,5	12	40	71	18	24	9x1,5	450	6500	
	XFEO45221406	10	06	3/8"	M22x1,5	14	42	72	19	27	10x2	450	6500	
	XFEO45221408	12	08	1/2"	M22x1,5	14	46	79	20	27	10x2	420	6000	
	XFEO45241608	12	08	1/2"	M24x1,5	16	47	80	21	30	12x2	420	6000	
	XFEO45302010	16	10	5/8"	M30x2	20	56	92	25	36	16,3x2,4	350	5000	
	XFEO45302012	20	12	3/4"	M30x2	20	64	105	27	36	16,3x2,4	350	5000	
	XFEO45362512	20	12	3/4"	M36x2	25	64	105	28	46	20,3x2,4	350	5000	
	XFEO45362512SW41	20	12	3/4"	M36x2	25	64	105	28	41	20,3x2,4	350	5000	
	XFEO45362516	25	16	1"	M36x2	25	82	133	34	41	22x2	280	4000	
	XFEO45423016	25	16	1"	M42x2	30	80	131	31	50	25,3x2,4	280	4000	
	XFEO45423020	32	20	1 1/4"	M42x2	30	96	154	41	50	25,3x2,4	210	3000	
	XFEO45523820	32	20	1 1/4"	M52x2	38	94	152	38	60	33,3x2,4	210	3000	
	XFEO45523824	40	24	1 1/2"	M52x2	38	115	180	49	60	33,3x2,4	185	2600	

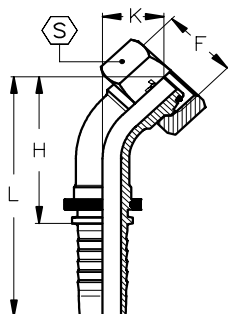

\* Swaged nut



ISO 12151-2 DIN 20078	DKOL90		90° METRIC SWEPT ELBOW - 24° O'RING CONE - LIGHT DUTY METRISCHE BOCHT 90° - 24° CONUS MET ORING - LICHTE SERIE										
	TIEFFE Part.N.	Hose I.D. Ø interno tubo			Thread Filettatura	Tube	Dimensions (mm)					Maximum W.P.	
		DN	Size	Inch	F	mm	H	L	K	S	O'Ring	bar	PSI
	XFE090120603	5	03	3/16"	M12x1,5	6	27	52	28	14	5x1	280	4000
	XFE090140803	5	03	3/16"	M14x1,5	8	27	52	28	17	6x1,5	280	4000
	XFE090120604	6	04	1/4"	M12x1,5	6	26	53	26	17	5x1	280	4000
	XFE090140804	6	04	1/4"	M14x1,5	8	29	57	29	17	6x1,5	280	4000
	XFE090161004	6	04	1/4"	M16x1,5	10	29	57	30	19	7,5x1,5	280	4000
	XFE090181204	6	04	1/4"	M18x1,5	12	29	57	32	22	9x1,5	280	4000
	XFE090161005	8	05	5/16"	M16x1,5	10	31	59	33	19	7,5x1,5	280	4000
	XFE090181205	8	05	5/16"	M18x1,5	12	28	56	32	22	9x1,5	280	4000
	XFE090161006	10	06	3/8"	M16x1,5	10	31	61	31	19	7,5x1,5	280	4000
	XFE090181206	10	06	3/8"	M18x1,5	12	31	61	33	22	9x1,5	280	4000
	XFE090221506	10	06	3/8"	M22x1,5	15	31	61	35	27	12x2	280	4000
	XFE090221508	12	08	1/2"	M22x1,5	15	37	70	38	27	12x2	280	4000
	XFE090261808	12	08	1/2"	M26x1,5	18	37	70	40	32	15x2	210	3000
	XFE090261810	16	10	5/8"	M26x1,5	18	44	80	45	32	15x2	210	3000
	XFE090302210	16	10	5/8"	M30x2	22	44	80	47	36	20x2	210	3000
	XFE090261812	20	12	3/4"	M26x1,5	18	54	94	57	32	15x2	210	3000
	XFE090302212	20	12	3/4"	M30x2	22	54	94	52	36	20x2	210	3000
	XFE090362816	25	16	1"	M36x2	28	70	121	66	41	26x2	165	2350
	XFE090453520	32	20	1 1/4"	M45x2	35	84	141	83	50	32x2,5	125	1800
	XFE090524224	40	24	1 1/2"	M52x2	42	100	164	100	60	38x2,5	100	1450

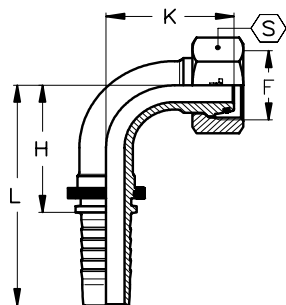

\* Swaged nut

\*\* Tieffe nut

ISO 12151-2 DIN 20078	DKOS90		90° METRIC SWEPT ELBOW - 24° O'RING CONE - HEAVY DUTY METRISCHE BOCHT 90° - 24° CONUS MET ORING - ZWARE SERIE										
	TIEFFE Part.N.	Hose I.D. Ø interno tubo			Thread Filettatura	Tube	Dimensions (mm)					Maximum W.P.	
		DN	Size	Inch	F	mm	H	L	K	S	O'Ring	bar	PSI
	XFE090140603	5	03	3/16"	M14x1,5	6	27	52	28	17	5x1	420	6000
	XFE090160803	5	03	3/16"	M16x1,5	8	27	52	28	19	6x1,5	420	6000
	XFE090140604	6	04	1/4"	M14x1,5	6	25	53	26	17	5x1	450	6500
	XFE090160804	6	04	1/4"	M16x1,5	8	29	57	29	19	6x1,5	450	6500
	XFE090181004	6	04	1/4"	M18x1,5	10	29	57	30	22	7,5x1,5	450	6500
	XFE090201204	6	04	1/4"	M20x1,5	12	29	57	32	24	9x1,5	450	6500
	XFE090181005	8	05	5/16"	M18x1,5	10	31	59	33	22	7,5x1,5	350	5000
	XFE090201205	8	05	5/16"	M20x1,5	12	28	56	32	24	9x1,5	350	5000
	XFE090181006	10	06	3/8"	M18x1,5	10	30	61	33	22	7,5x1,5	450	6500
	XFE090201206	10	06	3/8"	M20x1,5	12	31	61	33	24	9x1,5	450	6500
	XFE090221406	10	06	3/8"	M22x1,5	14	34	64	37	27	10x2	450	6500
	XFE090221408	12	08	1/2"	M22x1,5	14	39	71	41	27	10x2	420	6000
	XFE090241608	12	08	1/2"	M24x1,5	16	39	71	42	30	12x2	420	6000
	XFE090302010	16	10	5/8"	M30x2	20	44	80	49	36	16,3x2,4	350	5000
	XFE090302012	20	12	3/4"	M30x2	20	54	94	55	36	16,3x2,4	350	5000
	XFE090362512	20	12	3/4"	M36x2	25	54	94	57	46	20,3x2,4	350	5000
	XFE090362512SW41	20	12	3/4"	M36x2	25	54	94	57	41	20,3x2,4	350	5000
	XFE090362516	25	16	1"	M36x2	25	70	121	70	46	22x2	280	4000
	XFE090423016	25	16	1"	M42x2	30	70	121	66	50	25,3x2,4	280	4000
	XFE090423020	32	20	1 1/4"	M42x2	30	84	141	84	50	25,3x2,4	210	3000
	XFE090523820	32	20	1 1/4"	M52x2	38	84	141	80	60	33,3x2,4	210	3000
	XFE090523824	40	24	1 1/2"	M52x2	38	100	164	101	60	33,3x2,4	185	2600

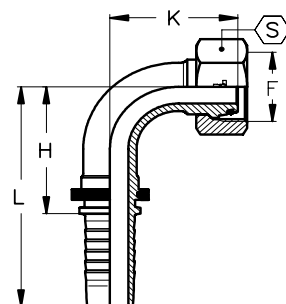

\* Swaged nut



TIEFFE Part. N.	90° METRIC STANDPIPE - ONE PIECE STANDPIJP METRISCH 90° - UIT 1 STUK										
	Hose I.D. Ø interno tubo			E mm	Dimensions (mm)						Maximum WP bar
	DN	Size	Inch		H	L	K	M			
<b>BEL 90</b>											
<b>BES 90</b>											
XEZ900603	5	03	3/16"	6	21	47	37,5	23			415
XEZ900803	5	03	3/16"	8	21	47	37,5	23			415
XEZ900604	6	04	1/4"	6	24	52	39	21			320
XEZ900804	6	04	1/4"	8	24	52	39	23			450
XEZ901004	6	04	1/4"	10	24	52	41	25			450
XEZ901204	6	04	1/4"	12	24	52	42,5	25			450
XEZ901005	8	05	5/16"	10	31	59	45	25			350
XEZ901205	8	05	5/16"	12	31	59	45	25			350
XEZ901006	10	06	3/8"	10	34	64	48	22			330
XEZ901206	10	06	3/8"	12	34	64	49	25			445
XEZ901406	10	06	3/8"	14	34	64	52	28			445
XEZ901506	10	06	3/8"	15	34	64	48	24			250
XEZ901408	12	08	1/2"	14	41	74	57,5	28			275
XEZ901508	12	08	1/2"	15	41	74	53,5	24			250
XEZ901608	12	08	1/2"	16	41	74	58,5	29			415
XEZ901808	12	08	1/2"	18	41	74	55,5	26			160
XEZ901810	16	10	5/8"	18	49	85	61,5	26			160
XEZ902010	16	10	5/8"	20	49	85	70,5	35			350
XEZ902210	16	10	5/8"	22	49	85	60	28			160
XEZ901812	20	12	3/4"	18	58	99	69	26			160
XEZ902012	20	12	3/4"	20	58	99	78	35			215
XEZ902212	20	12	3/4"	22	58	99	71	28			160
XEZ902512	20	12	3/4"	25	58	99	82	39			350
XEZ902516	25	16	1"	25	74	129	99	39			165
XEZ902816	25	16	1"	28	74	129	89	29			100
XEZ903010	25	16	1"	30	74	129	96	43			250
XEZ903020	32	20	1 1/4"	30	92	153	110	43			210
XEZ903520	32	20	1 1/4"	35	92	153	107	35			100
XEZ903820	32	20	1 1/4"	38	92	153	115	48			210
XEZ903824	40	24	1 1/2"	38	108	179	128	48			170
XEZ904224	40	24	1 1/2"	42	108	179	120	36			100

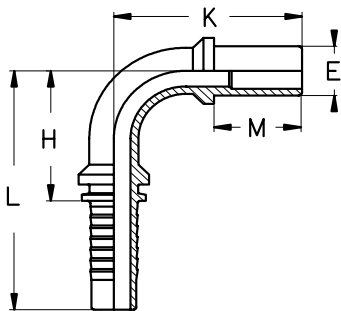

**BEL 45  
BES 45**

**45° METRIC STANDPIPE - ONE PIECE  
STANDPIJP METRISCH 45° - UIT 1 STUK**

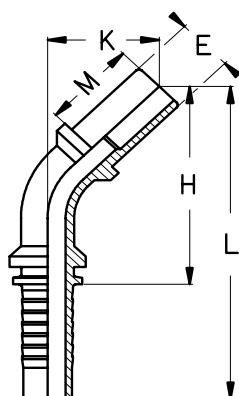

TIEFFE Part. N.	Hose I.D. Ø interno tubo			E mm	Dimensions (mm)						Maximum WP bar
	DN	Size	Inch		H	L	K	M			
XEZ450603	5	03	3/16"	6	44,5	70	22,5	23			415
XEZ450803	5	03	3/16"	8	44,5	70	22,5	23			415
XEZ450604	6	04	1/4"	6	48	77	24	21			320
XEZ450804	6	04	1/4"	8	48	76,5	24	23			450
XEZ451004	6	04	1/4"	10	49,5	78	25,5	25			450
XEZ451204	6	04	1/4"	12	50,5	79	26,5	25			450
XEZ451005	8	05	5/16"	10	51,5	80	27,5	25			350
XEZ451205	8	05	5/16"	12	57,5	86	27,5	25			350
XEZ451006	10	06	3/8"	10	62	92,5	27,5	22			330
XEZ451206	10	06	3/8"	12	62,5	93	28,5	25			445
XEZ451406	10	06	3/8"	14	64,5	95	30,5	28			445
XEZ451506	10	06	3/8"	15	61,5	92,5	27,5	24			250
XEZ451408	12	08	1/2"	14	73,5	106,5	34	28			275
XDEZ451508	12	08	1/2"	15	70,5	103,5	31	24			250
XEZ451608	12	08	1/2"	16	74	107	34,5	29			415
XEZ451808	12	08	1/2"	18	72	105	32,5	26			160
XEZ451810	16	10	5/8"	18	86,5	122,5	34	26			160
XEZ452010	16	10	5/8"	20	92,5	128,5	40,5	35			350
XEZ452210	16	10	5/8"	22	85,5	121,5	33	28			160
XEZ451812	20	12	3/4"	18	94,5	135,5	41	26			160
XEZ452012	20	12	3/4"	20	100,5	141,5	47	35			215
XEZ452212	20	12	3/4"	22	96	137	42,5	28			160
XEZ452512	20	12	3/4"	25	103,5	144,5	50	39			350
XEZ452516	25	16	1"	25	131	186	63	39			165
XEZ452816	25	16	1"	28	124	178	56	29			100
XEZ453016	25	16	1"	30	126,5	181,5	58,5	43			250
XEZ453020	32	20	1 1/4"	30	152,5	213,5	69	43			210
XEZ453520	32	20	1 1/4"	35	153	214	69	35			100
XEZ453820	32	20	1 1/4"	38	156	217	72,5	48			210
XEZ453824	40	24	1 1/2"	38	184	254	79	48			170
XEZ454224	40	24	1 1/2"	42	175	246	71	36			100





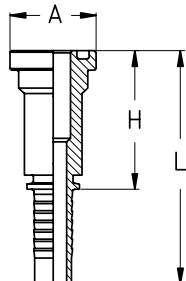

\* Straight Komatsu Flange  
Flangia Diritta Komatsu

TIEFFE Part. N.	Hose I.D.			Flange Flangia	Maximum WP
	DN	Size	Inch		
X30808B	12	08	1/2"	1/2"	350
X31208B	12	08	1/2"	3/4"	350
* X31008B	12	08	1/2"	5/8"	350
X30810B	16	10	5/8"	1/2"	350
* X31010B	16	10	5/8"	5/8"	350
X31210B	16	10	5/8"	3/4"	350
X30812B	20	12	3/4"	1/2"	350
X31212B	20	12	3/4"	3/4"	350
X31612B	20	12	3/4"	1"	350
X31216B	25	16	1"	3/4"	280
X31616B	25	16	1"	1"	280
X32016B	25	16	1"	1 1/4"	280
X31620B	32	20	1 1/4"	1"	210
X32020B	32	20	1 1/4"	1 1/4"	210
X32420B	32	20	1 1/4"	1 1/2"	210
X32424B	40	24	1 1/2"	1 1/2"	185
X33224B	40	24	1 1/2"	2"	185
X33232B	50	32	2"	2"	170
X34032B	50	32	2"	2 1/2"	170

## SFL90

### 90° SAE J518 FLANGE - 3000 PSI - ONE PIECE FLANGIA 90° SAE J518 - 3000 PSI - INTERA

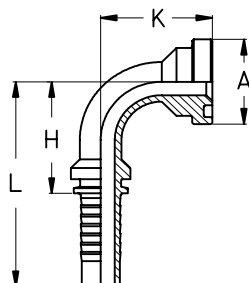

\* 90° Komatsu Flange  
Flangia 90° Komatsu

TIEFFE Part. N.	Hose I.D.			Flange Flangia	Dimensions (mm)				Maximum WP
	DN	Size	Inch		H	L	K	A	
X3900808B	12	08	1/2"	1/2"	41	74	42	30,2	350
X3901208B	12	08	1/2"	3/4"	41	74	47	38,1	350
* X3901008B	12	08	1/2"	5/8"	41	74	44	34,0	350
X3901008B	16	10	5/8"	1/2"	49	85	46	30,2	350
* X3901010B	16	10	5/8"	5/8"	49	85	49	34,0	350
X3901210B	16	10	5/8"	3/4"	49	85	52	38,1	350
X3900812B	20	12	3/4"	1/2"	58	99	51	30,2	350
X3901212B	20	12	3/4"	3/4"	58	99	57	38,1	350
X3901612B	20	12	3/4"	1"	58	99	62	44,5	350
X3901216B	25	16	1"	3/4"	74	129	69	38,1	280
X3901616B	25	16	1"	1"	74	129	69	44,5	280
X3902016B	25	16	1"	1 1/4"	74	129	70	50,8	280
X3901620B	32	20	1 1/4"	1"	92	153	78	44,5	210
X3902020B	32	20	1 1/4"	1 1/4"	92	153	87	50,8	210
X3902420B	32	20	1 1/4"	1 1/2"	92	153	88	60,3	210
X3902424B	40	24	1 1/2"	1 1/2"	108	179	101	60,3	185
X3903224B	40	24	1 1/2"	2"	108	179	104	71,4	185
X3903232B	50	32	2"	2"	142	218	134	71,4	170
X3904032B	50	32	2"	2 1/2"	142	218	143	84,1	170









TIEFFE Part. N.	STRAIGHT "SUPERCAT" FLANGE - ONE PIECE RECHTE FLENS "SUPERCAT" - UIT 1 STUK									
	Hose I.D. Ø interno tubo			Flange Flangia	Dimensions (mm)					Maximum WP
	DN	Size	Inch	Inch	H	L	A			bar
<b>XC1212</b>	20	12	3/4"	3/4"	65,5	106,0	41,3			350
<b>XC1612</b>	20	12	3/4"	1"	67,5	108,0	47,6			350
<b>XC1616</b>	25	16	1"	1"	71,5	126,0	47,6			280
<b>XC2016</b>	25	16	1"	1 1/4"	74,5	129,5	54,0			280
<b>XC2020</b>	32	20	1 1/4"	1 1/4"	75,0	136,0	54,0			210
<b>XC2420</b>	32	20	1 1/4"	1 1/2"	82,0	143,0	63,5			210
<b>XC2424</b>	40	24	1 1/2"	1 1/2"	83,0	153,0	63,5			185

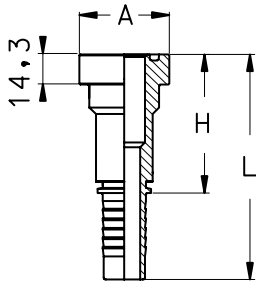

TIEFFE Part. N.	90° "SUPERCAT" FLANGE - ONE PIECE FLENS 90° "SUPERCAT" - UIT 1 STUK									
	Hose I.D. Ø interno tubo			Flange Flangia	Dimensions (mm)					Maximum WP
	DN	Size	Inch	Inch	H	L	K	A		bar
<b>XC901212</b>	20	12	3/4"	3/4"	58	99	67	41,3		350
<b>XC901612</b>	20	12	3/4"	1"	58	99	75	47,6		350
<b>XC901616</b>	25	16	1"	1"	74	129	80	47,6		280
<b>XC902016</b>	25	16	1"	1 1/4"	74	129	86	54,0		280
<b>XC902020</b>	32	20	1 1/4"	1 1/4"	92	153	94	54,0		210
<b>XC902420</b>	32	20	1 1/4"	1 1/2"	92	153	98	63,5		210
<b>XC902424</b>	40	24	1 1/2"	1 1/2"	108	179	103	63,5		185

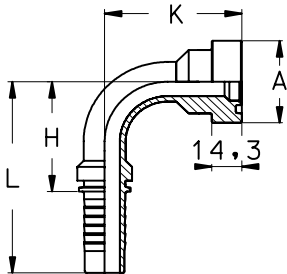

TIEFFE Part. N.	45° "SUPERCAT" FLANGE - ONE PIECE FLENS 45° "SUPERCAT" - UIT 1 STUK									
	Hose I.D. Ø interno tubo			Flange Flangia	Dimensions (mm)					Maximum WP
	DN	Size	Inch	Inch	H	L	K	A		bar
<b>XC451212</b>	20	12	3/4"	3/4"	94,0	135,0	40,0	41,3		350
<b>XC451612</b>	20	12	3/4"	1"	99,0	140,0	45,0	47,6		350
<b>XC451616</b>	25	16	1"	1"	111,5	170,5	47,5	47,6		280
<b>XC452016</b>	25	16	1"	1 1/4"	120,0	175,0	51,5	54		280
<b>XC452020</b>	32	20	1 1/4"	1 1/4"	141,5	202,5	58,0	54		210
<b>XC452420</b>	32	20	1 1/4"	1 1/2"	144,5	205,5	60,5	63,5		210
<b>XC452424</b>	40	24	1 1/2"	1 1/2"	163,5	234,0	60,0	63,5		185

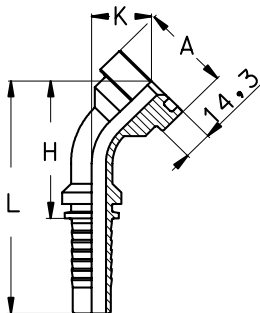

<b>"KOMATSU" METRIC FEMALE - 60° CONE SEAT - CRIMPED NUT METR. WARTELKOPP. "KOMATSU" - CONUS 60° - GEKROMPEN MOER</b>										
TIEFFE Part. N.	Hose I.D. Ø interno tubo			Thread Filetto F	Dimensions (mm)					
	DN	Size	Inch		H	L	S	S1		
XFMJ1404	6	04	1/4"	M14x1,5	24,0	52,5	19	19		
XFMJ1605	8	05	5/16"	M16x1,5	22,2	50,7	22	19		
XFMJ1406	10	06	3/8"	M14x1,5	24,0	54,5	19	19		
XFMJ1606	10	06	3/8"	M16x1,5	22,2	52,7	22	19		
XFMJ1806	10	06	3/8"	M18x1,5	24,3	54,8	24	19		
XFMJ2208	12	08	1/2"	M22x1,5	26,5	59,5	27	27		
XFMJ2408	12	08	1/2"	M24x1,5	29,9	62,9	32	32		
XFMJ2410	16	10	5/8"	M24x1,5	29,9	65,9	32	32		
XFMJ3012	20	12	3/4"	M30x1,5	33,0	74,0	36	36		
XFMJ3316	25	16	1"	M33x1,5	34,5	89,5	41	36		
XFMJ3620	32	20	1 1/4"	M36x1,5	42,6	103,6	46	46		
XFMJ4224	40	24	1 1/2"	M42x1,5	43,5	114,0	50	50		

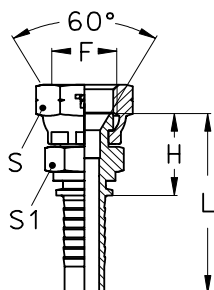

<b>"TOYOTA" B.S.P. FEMALE - 60° CONE SEAT - CRIMPED NUT BSP WARTELKOPP. "TOYOTA" - CONUS 60° - GEKROMPEN MOER</b>										
TIEFFE Part. N.	Hose I.D. Ø interno tubo			Thread Filetto F	Dimensions (mm)					
	DN	Size	Inch		H	L	S	S1		
XBFJ0404	6	04	1/4"	1/4"	21,8	50,3	19	17		
XBFJ0606	10	06	3/8"	3/8"	22,5	53,0	22	19		
XBFJ0808	12	08	1/2"	1/2"	25,2	58,2	27	22		
XBFJ1212	20	12	3/4"	3/4"	29,7	70,7	32	27		
XBFJ1616	25	16	1"	1"	34,3	89,3	41	32		
XBFJ2020	32	20	1 1/4"	1 1/4"	37,0	98,0	50	41		
XBFJ2424	40	24	1 1/2"	1 1/2"	40,2	110,7	55	50		

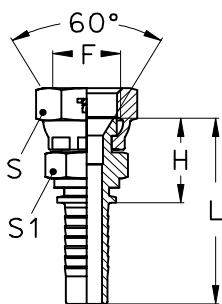

<b>DKOK WASHCLEANER FEMALE - "FK" TYPE CLEANER SLANGKOPPELING - TYPE "FK"</b>										
TIEFFE Part. N.	Hose I.D. Ø interno tubo			Thread Filetto F	Dimensions (mm)					
	DN	Size	Inch		H	L	D			
XKF221404	6	04	1/4"	M22x1,5	36,5	65	14			
XKF221405	8	05	5/16"	M22x1,5	36,5	65	14			
XKF221406	10	06	3/8"	M22x1,5	36,5	67	14			

