

YBM

BSP MALE - PARALLEL - 60° CONE SEAT BU.DR. SLANGKOPPELING BSP - CONUS 60°

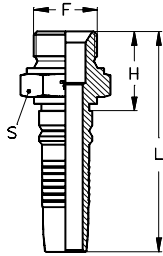

TIEFFE Part.N.	Hose I.D. Ø interno tubo			Thread Filetto	Dimensions (mm)					W. P. (max) bar
	DN	SIZE	Inch		F	H	L	S		
YBM1212	19	12	3/4"	3/4"-14	35	97	32			420
YBM1616	25	16	1"	1"-11	41	114	41			414
YBM2016	25	16	1"	1 1/4"-11	44	117	50			414
YBM2020	31	20	1 1/4"	1 1/4"-11	46	134	50			414
YBM2424	38	24	1 1/2"	1 1/2"-11	49	143	55			345
YBM3232	51	32	2"	2"-11	56	154	70			345

YBT

BSP TAPER MALE - 60° CONE SEAT BU.DR. SLANGKOPPELING BSP TAPS - CONUS 60°

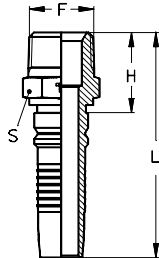

TIEFFE Part.N.	Hose I.D. Ø interno tubo			Thread Filetto	Dimensions (mm)					W. P. (max) bar
	DN	SIZE	Inch		F	H	L	S		
YBT1212	19	12	3/4"	3/4"-14	34	96	27			420
YBT1616	25	16	1"	1"-11	40	113	36			414
YBT2020	31	20	1 1/4"	1 1/4"-11	47	135	46			414
YBT2424	38	24	1 1/2"	1 1/2"-11	48	142	50			345
YBT3232	51	32	2"	2"-11	57	155	65			345

YBF

BSP STRAIGHT FEMALE - 60° O'RING CONE - TIEFFE NUT SLANGKOPP. RECHT BSP - CONUS 60° O'RING - TIEFFE MOER

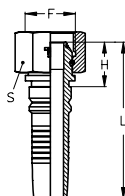

TIEFFE Part.N.	Hose I.D. Ø interno tubo			Thread Filetto F	Dimensions (mm)					W. P. (max) bar
	DN	SIZE	Inch		H	L	S	O'Ring		
YBF1212	19	12	3/4"	3/4"-14	25	87	32	16x1,5	420	
YBF1616	25	16	1"	1"-11	30	103	41	22x1,5	414	
YBF2016	25	16	1"	1 1/4"-11	33	106	50	28,3x1,78	414	
YBF2020	31	20	1 1/4"	1 1/4"-11	35	122	50	28,3x1,78	414	
YBF2424	38	24	1 1/2"	1 1/2"-11	36	130	60	33,05x1,78	345	
YBF3232	51	32	2"	2"-11	40	138	75	44,17x1,78	345	

YBF90

90° BSP SWEPT ELBOW - 60° O'RING CONE - ONE PIECE - TIEFFE NUT SLANGKOPP. 90° BSP - CONUS 60° O'RING - UIT 1 STUK - TIEFFE MOER

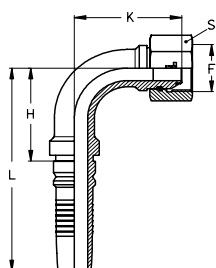

TIEFFE Part.N.	Hose I.D. Ø interno tubo			Thread Filetto F	Dimensions (mm)					W. P. (max) bar
	DN	SIZE	Inch		H	L	K	S	O'Ring	
YBF901212	19	12	3/4"	3/4"-14	55	117	63	32	16x1,5	420
YBF901616	25	16	1"	1"-11	71	144	79	41	22x1,5	414
YBF902016	25	16	1"	1 1/4"-11	71	144	81	50	28,3x1,78	414
YBF902020	31	20	1 1/4"	1 1/4"-11	90	177	96	50	28,3x1,78	414
YBF902424	38	24	1 1/2"	1 1/2"-11	107	201	113	60	33,05x1,78	345
YBF903232	51	32	2"	2"-11	142	240	140	75	44,17x1,78	345

YBF45

45° BSP SWEPT ELBOW - 60° O'RING CONE - ONE PIECE - TIEFFE NUT SLANGKOPP. 45° BSP - CONUS 60° O'RING - UIT 1 STUK - TIEFFE MOER

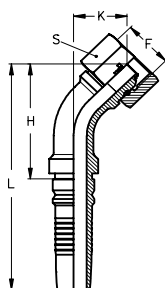

TIEFFE Part.N.	Hose I.D. Ø interno tubo			Thread Filetto F	Dimensions (mm)					W. P. (max) bar
	DN	SIZE	Inch		H	L	K	S	O'Ring	
YBF451212	19	12	3/4"	3/4"-14	68	130	32	32	16x1,5	420
YBF451616	25	16	1"	1"-11	86	159	39	41	22x1,5	414
YBF452016	25	16	1"	1 1/4"-11	88	161	41	50	28,3x1,78	414
YBF452020	31	20	1 1/4"	1 1/4"-11	107	195	47	50	28,3x1,78	414
YBF452424	38	24	1 1/2"	1 1/2"-11	126	220	55	60	33,05x1,78	345
YBF453232	51	32	2"	2"-11	160	258	66	75	44,17x1,78	345

YJM

J.I.C. MALE - 74° CONE BU.DR. SLANGKOPPELING J.I.C. - CONUS 74°

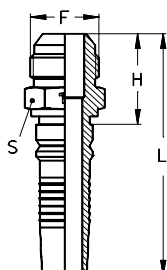

TIEFFE Part.N.	Hose I.D. Ø interno tubo			Thread Filetto F	Dimensions (mm)			W. P. (max) bar
	DN	SIZE	Inch		H	L	S	
YJM1712	19	12	3/4"	1 1/16"-12	38	99	27	420
YJM1912	19	12	3/4"	1 3/16"-12	39	101	32	420
YJM2112	19	12	3/4"	1 5/16"-12	41	102	36	420
YJM2116	25	16	1"	1 5/16"-12	42	114	36	414
YJM2616	25	16	1"	1 5/8"-12	45	117	46	414
YJM2620	31	20	1 1/4"	1 5/8"-12	47	134	46	414
YJM3020	31	20	1 1/4"	1 7/8"-12	51	139	50	414
YJM3024	38	24	1 1/2"	1 7/8"-12	52	145	50	345
YJM4032	51	32	2"	2 1/2"-12	63	160	65	345

YNM

NPTF MALE - 60° CONE SEAT BU.DR. SLANGKOPP. NPTF - CONUS 60°

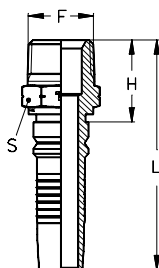

TIEFFE Part.N.	Hose I.D. Ø interno tubo			Thread Filetto F	Dimensions (mm)			W. P. (max) bar
	DN	SIZE	Inch		H	L	S	
YNM1212	20	12	3/4"	3/4"-14	34	98	27	420
YNM1612	20	12	3/4"	1"-11,5	42	103	36	420
YNM1616	25	16	1"	1"-11,5	42	115	36	420
YNM2016	25	16	1"	1 1/4"-11,5	45	118	46	420
YNM2020	32	20	1 1/4"	1 1/4"-11,5	47	135	46	420
YNM2420	32	20	1 1/4"	1 1/2"-11,5	50	137	50	420
YNM2424	40	24	1 1/2"	1 1/2"-11,5	50	144	50	345
YNM3232	50	32	2"	2"-11,5	55	153	60	345

YJF

J.I.C. STRAIGHT FEMALE - 74° CONE SEAT - TIEFFE NUT SLANGKOPP. WARTEL J.I.C. - CONUS 74° - TIEFFE MOER

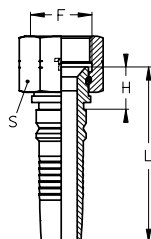

TIEFFE Part.N.	Hose I.D. Ø interno tubo			Thread Filetto F	Dimensions (mm)					W. P. (max) bar
	DN	SIZE	Inch		H	L	S			
YJF1712	19	12	3/4"	1 1/16"-12	20	82		32		420
YJF1912	19	12	3/4"	1 3/16"-12	21,5	83		36		420
YJF2112	19	12	3/4"	1 5/16"-12	22,5	84		41		420
YJF2116	25	16	1"	1 5/16"-12	23,5	96		41		414
YJF2616	25	16	1"	1 5/8"-12	28	101		50		414
YJF2620	31	20	1 1/4"	1 5/8"-12	29	117		50		414
YJF3020	31	20	1 1/4"	1 7/8"-12	29,5	117		60		414
YJF3024	38	24	1 1/2"	1 7/8"-12	30	124		60		345
YJF4032	51	32	2"	2 1/2"-12	37	135		75		345

YJF90

J.I.C. 90° SWEPT ELBOW - 74° CONE SEAT - ONE PIECE - TIEFFE NUT BOCHT 90° J.I.C. - CONUS 74° - UIT 1 STUK - TIEFFE MOER

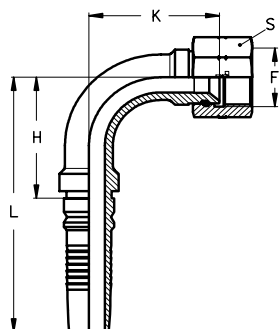

TIEFFE Part.N.	Hose I.D. Ø interno tubo			Thread Filetto F	Dimensions (mm)					W. P. (max) bar
	DN	SIZE	Inch		H	L	K	S		
YJF901712	19	12	3/4"	1 1/16"-12	55	117	58	32		420
YJF901912	19	12	3/4"	1 3/16"-12	55	117	59	36		420
YJF902112	19	12	3/4"	1 5/16"-12	55	117	63	41		420
YJF902116	25	16	1"	1 5/16"-12	71	144	73	41		414
YJF902616	25	16	1"	1 5/8"-12	71	144	76	50		414
YJF902620	31	20	1 1/4"	1 5/8"-12	90	177	91	50		414
YJF903020	31	20	1 1/4"	1 7/8"-12	90	177	91	60		414
YJF903024	38	24	1 1/2"	1 7/8"-12	107	201	106	60		345
YJF904032	51	32	2"	2 1/2"-12	140	240	139	75		345

YJF45

J.I.C. 45° SWEPT ELBOW - 74° CONE SEAT - ONE PIECE - TIEFFE NUT BOCHT 45° J.I.C. - CONUS 74° - UIT 1 STUK - TIEFFE MOER

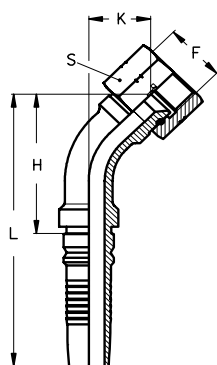

TIEFFE Part.N.	Hose I.D. Ø interno tubo			Thread Filetto F	Dimensions (mm)					W. P. (max) bar
	DN	SIZE	Inch		H	L	K	S		
YJF451712	19	12	3/4"	1 1/16"-12	64	126	28	32		420
YJF451912	19	12	3/4"	1 3/16"-12	65	127	29	36		420
YJF452112	19	12	3/4"	1 5/16"-12	68	130	32	41		420
YJF452116	25	16	1"	1 5/16"-12	82	155	35	41		414
YJF452616	25	16	1"	1 5/8"-12	84	157	37	50		414
YJF452620	31	20	1 1/4"	1 5/8"-12	103	191	43	50		414
YJF453020	31	20	1 1/4"	1 7/8"-12	103	191	43	60		414
YJF453024	38	24	1 1/2"	1 7/8"-12	121	215	50	60		345
YJF454032	51	32	2"	2 1/2"-12	158	256	65	75		345

YMU
ORFS MALE

SLANGKOPPELING BU.DR. ORFS

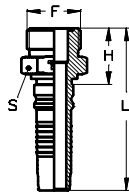

TIEFFE Part.N.	Hose I.D. Ø interno tubo			Thread Filetto	Dimensions (mm)					W. P. (max)
	DN	SIZE	Inch	F	H	L	S	O'Ring**	bar	
YMU1912	19	12	3/4"	1 3/16"-12	34	95	32	18,77x1,78	420	
YMU2116	25	16	1"	1 7/16"-12	37	110	41	23,52x1,78	414	
YMU2720	31	20	1 1/4"	1 11/16"-12	40	128	46	29,87x1,78	250	
YMU3224	38	24	1 1/2"	2"-12	43	136	55	37,82x1,78	250	

YFU
ORFS FEMALE

SLANGKOPP. WARTEL ORFS

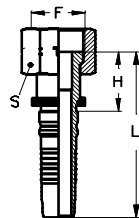

TIEFFE Part.N.	Hose I.D. Ø interno tubo			Thread Filetto	Dimensions (mm)					W. P. (max)
	DN	SIZE	Inch	F	H	L	S	O'Ring**	bar	
YFU1912	19	12	3/4"	1 3/16"-12	35	97	36		420	
YFU2116	25	16	1"	1 7/16"-12	37	110	41		414	
YFU2720	31	20	1 1/4"	1 11/16"-12	38	126	50		250	
YFU3224	38	24	1 1/2"	2"-12	39	132	60		250	

YFU90
90° ORFS SWEPT ELBOW

SLANGKOPP. WARTEL 90° ORFS

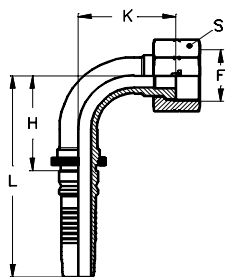

TIEFFE Part.N.	Hose I.D. Ø interno tubo			Thread Filetto	Dimensions (mm)					W. P. (max)
	DN	SIZE	Inch	F	H	L	K	S	bar	
YFU901912	19	12	3/4"	1 3/16"-12	56	118	55	36	420	
YFU902116	25	16	1"	1 7/16"-12	71	144	67	41	414	
YFU902720	31	20	1 1/4"	1 11/16"-12	90	177	81	50	250	
YFU903224	38	24	1 1/2"	2"-12	107	201	95	60	250	

YFU45
45° ORFS SWEPT ELBOW

SLANGKOPP. WARTEL 45° ORFS

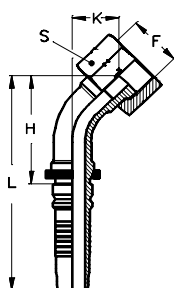

TIEFFE Part.N.	Hose I.D. Ø interno tubo			Thread Filetto	Dimensions (mm)					W. P. (max)
	DN	SIZE	Inch	F	H	L	K	S	bar	
YFU451912	19	12	3/4"	1 3/16"-12	63	125	26	36	420	
YFU452116	25	16	1"	1 7/16"-12	78	151	31	41	414	
YFU452720	31	20	1 1/4"	1 11/16"-12	96	184	36	50	250	
YFU453224	38	24	1 1/2"	2"-12	113	207	42	60	250	

** The "Part.N." do not include O'Ring.

** IL "Part.N." non comprende O'Ring.

YME METRIC MALE - 24° CONE SEAT - HEAVY TYPE SLANGKOPP. BU.DR. METRISCH - CONUS 24° - ZWARE SERIE

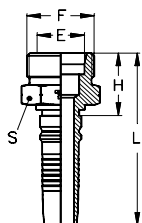

TIEFFE Part.N.	Hose I.D. Ø interno tubo			Thread Filetto	Dimensions (mm)					W. P. (max) bar
	DN	SIZE	Inch		F	H	L	S	E (PIPE)	
YME302012	19	12	3/4"	M 30x2	31	93		30	20	420
YME362512	19	12	3/4"	M 36x2	35	97		36	25	420
YME362516	25	16	1"	M 36x2	36	109		36	25	414
YME423016	25	16	1"	M 42x2	40	113		46	30	280
YME423020	31	20	1 1/4"	M 42x2	42	130		46	30	250
YME523820	31	20	1 1/4"	M 52x2	46	134		55	38	250
YME523824	38	24	1 1/2"	M 52x2	47	141		55	38	250

YFEO O'RING METRIC FEMALE - 24° CONE - HEAVY TYPE SLANGKOPP. WARTEL METRISCH - CONUS 24° O'RING - ZWARE SERIE

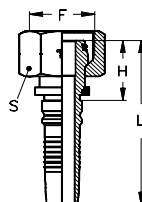

TIEFFE Part.N.	Hose I.D. Ø interno tubo			Thread Filetto	Dimensions (mm)					W. P. (max) bar
	DN	SIZE	Inch		F	H	L	S	O'Ring	
YFEO302012	19	12	3/4"	M 30x2	33	95		36	16,3x2,4	420
YFEO362512	19	12	3/4"	M 36x2	36	98		41	20,3x2,4	420
YFEO362516	25	16	1"	M 36x2	37	110		41	22x2	414
YFEO423016	25	16	1"	M 42x2	39	112		50	25,3x2,4	280
YFEO423020	31	20	1 1/4"	M 42x2	41	128		50	25,3x2,4	250
YFEO523820	31	20	1 1/4"	M 52x2	43	131		60	33,3x2,4	250
YFEO523824	38	24	1 1/2"	M 52x2	44	138		60	33,3x2,4	250

YFEO90 90° METRIC SWEEP ELBOW - 24° CONE - HEAVY TYPE BOCHT 90° METRISCH - CONUS 24° O'RING - ZWARE SERIE

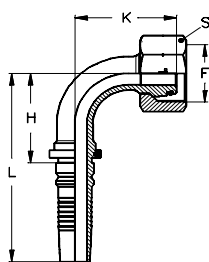

TIEFFE Part.N.	Hose I.D. Ø interno tubo			Thread Filetto	Dimensions (mm)					W. P. (max) bar
	DN	SIZE	Inch		F	H	L	K	S	
YFEO90302012	19	12	3/4"	M 30x2	55	117	60	36	16,3x2,4	420
YFEO90362512	19	12	3/4"	M 36x2	55	117	60	41	20,3x2,4	420
YFEO90362516	25	16	1"	M 36x2	71	144	71	41	22x2	414
YFEO90423016	25	16	1"	M 42x2	71	144	71	50	25,3x2,4	280
YFEO90423020	31	20	1 1/4"	M 42x2	90	177	85	50	25,3x2,4	250
YFEO90523820	31	20	1 1/4"	M 52x2	90	177	86	60	33,3x2,4	250
YFEO90523824	38	24	1 1/2"	M 52x2	107	201	98	60	33,3x2,4	250

YFEO45 45° METRIC SWEEP ELBOW - 24° CONE - HEAVY TYPE BOCHT 45° METRISCH - CONUS 24° O'RING - ZWARE SERIE

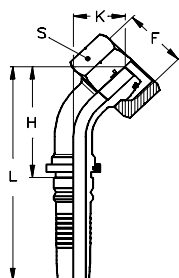

TIEFFE Part.N.	Hose I.D. Ø interno tubo			Thread Filetto	Dimensions (mm)					W. P. (max) bar
	DN	SIZE	Inch		F	H	L	K	S	
YFEO45302012	19	12	3/4"	M 30x2	67	129	29	36	16,3x2,4	420
YFEO45362512	19	12	3/4"	M 36x2	66	128	30	41	20,3x2,4	420
YFEO4536216	25	16	1"	M 36x2	81	154	33	41	22x2	414
YFEO45423016	25	16	1"	M 42x2	81	154	33	50	25,3x2,4	280
YFEO45423020	31	20	1 1/4"	M 42x2	99	187	39	50	25,3x2,4	250
YFEO45523820	31	20	1 1/4"	M 52x2	100	188	40	60	33,3x2,4	250
YFEO45523824	38	24	1 1/2"	M 52x2	116	210	44	60	33,3x2,4	250

Y3

STRAIGHT SAE J518 FLANGE - 3000 PSI - ONE PIECE RECHTE FLENS SAE J518 - 3000 PSI - UIT 1 STUK

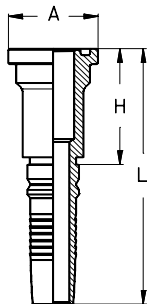

TIEFFE Part.N.	Hose I.D. Ø interno tubo			Flange Flangia	Dimensions (mm)					W. P. (max) bar
	DN	SIZE	Inch		H	L		A	O'Ring**	
Y31212	19	12	3/4"	3/4"	52	113		38	24,99x3,53	350
Y31612	19	12	3/4"	1"	58	119		44,5	32,92x3,53	350
Y31612	25	16	1"	3/4"	53	125		38	24,99x3,53	350
Y31616	25	16	1"	1"	59	131		44,5	32,92x3,53	350
Y32016	25	16	1"	1 1/4"	63	135		51	37,69x3,53	250
Y32020	31	20	1 1/4"	1 1/4"	64	151		51	37,69x3,53	250
Y32420	31	20	1 1/4"	1 1/2"	69	156		60,5	47,22x3,53	200
Y32424	38	24	1 1/2"	1 1/2"	69	163		60,5	47,22x3,53	200
Y33224	38	24	1 1/2"	2"	74	168		71,5	56,74x3,53	200
Y33232	51	32	2"	2"	76	173		71,5	56,74x3,53	200

Y390

90° SWEPT ELBOW - SAE J518 FLANGE - 3000 PSI - ONE PIECE BOCHT 90° - FLENS SAE J518 - 3000 PSI - UIT 1 STUK

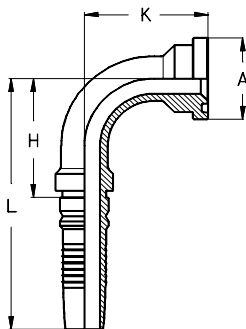

TIEFFE Part.N.	Hose I.D. Ø interno tubo			Flange Flangia	Dimensions (mm)					W. P. (max) bar
	DN	SIZE	Inch		H	L	K	A	O'Ring**	
Y3901212	19	12	3/4"	3/4"	56	118	56	38	24,99x3,53	350
Y3901612	19	12	3/4"	1"	56	118	61	44,5	32,92x3,53	350
Y3901216	25	16	1"	3/4"	72	145	67	38	24,99x3,53	350
Y3901616	25	16	1"	1"	72	145	68	44,5	32,92x3,53	350
Y3902016	25	16	1"	1 1/4"	72	145	70	51	37,69x3,53	250
Y3902020	31	20	1 1/4"	1 1/4"	91	178	85	51	37,69x3,53	250
Y3902420	31	20	1 1/4"	1 1/2"	91	178	85	60,5	47,22x3,53	200
Y3902424	38	24	1 1/2"	1 1/2"	108	202	100	60,5	47,22x3,53	200
Y3903224	38	24	1 1/2"	2"	108	202	102	71,5	56,74x3,53	200
Y3903232	51	32	2"	2"	143	281	129	71,5	56,74x3,53	200

Y345

45° SWEPT ELBOW - SAE J518 FLANGE - 3000 PSI - ONE PIECE BOCHT 45° - FLENS SAE J518 - 3000 PSI - UIT 1 STUK

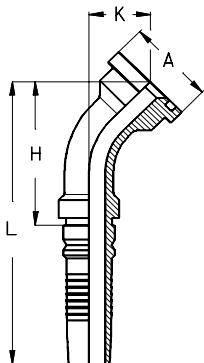

TIEFFE Part.N.	Hose I.D. Ø interno tubo			Flange Flangia	Dimensions (mm)					W. P. (max) bar
	DN	SIZE	Inch		H	L	K	A	O'Ring**	
Y3451212	19	12	3/4"	3/4"	63	125	27	38	24,99x3,53	350
Y3451612	19	12	3/4"	1"	67	129	31	44,5	32,92x3,53	350
Y3451216	25	16	1"	3/4"	78	151	31	38	24,99x3,53	350
Y3451616	25	16	1"	1"	79	152	32	44,5	32,92x3,53	350
Y3452016	25	16	1"	1 1/4"	80	153	33	51	37,69x3,53	250
Y3452020	31	20	1 1/4"	1 1/4"	99	187	39	51	37,69x3,53	250
Y3452420	31	20	1 1/4"	1 1/2"	99	187	39	60,5	47,22x3,53	200
Y3452424	38	24	1 1/2"	1 1/2"	117	211	46	60,5	47,22x3,53	200
Y3453224	38	24	1 1/2"	2"	118	212	47	71,5	56,74x3,53	200
Y3453232	51	32	2"	2"	152	250	58	71,5	56,74x3,53	200

** The "Part.N." do not include O'Ring.

** IL "Part.N." non comprende O'Ring.

Y6

STRAIGHT SAE J518 FLANGE - 6000 PSI - ONE PIECE RECHTE FLENS SAE J518 - 6000 PSI - UIT 1 STUK

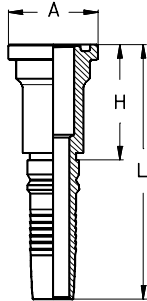

TIEFFE Part.N.	Hose I.D. Ø interno tubo			Flange Flangia	Dimensions (mm)					W. P. (max) bar
	DN	SIZE	Inch		H	L		A	O'Ring**	
Y61212	19	12	3/4"	3/4"	58	120		41,3	24,99x3,53	420
Y61612	19	12	3/4"	1"	60	122		47,6	32,92x3,53	420
Y61216	25	16	1"	3/4"	59	132		41,3	24,99x3,53	415
Y61616	25	16	1"	1"	64	137		47,6	32,92x3,53	415
Y62016	25	16	1"	1 1/4"	68	141		54	37,69x3,53	415
Y62020	31	20	1 1/4"	1 1/4"	69	157		54	37,69x3,53	415
Y62420	31	20	1 1/4"	1 1/2"	79	166		63,5	47,22x3,53	415
Y62424	38	24	1 1/2"	1 1/2"	79	173		63,5	47,22x3,53	345
Y63232	51	32	2"	2"	97	195		79,4	56,74x3,53	345

Y690

90° SWEPT ELBOW - SAE J518 FLANGE - 6000 PSI - ONE PIECE BOCHT 90° - FLENS SAE J518 - 6000 PSI - UIT 1 STUK

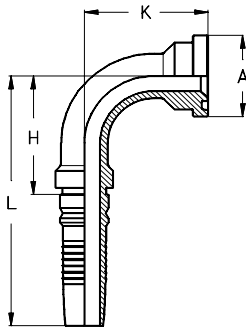

TIEFFE Part.N.	Hose I.D. Ø interno tubo			Flange Flangia	Dimensions (mm)					W. P. (max) bar
	DN	SIZE	Inch		H	L	K	A	O'Ring**	
Y6901212	19	12	3/4"	3/4"	56	118	61	41,3	24,99x3,53	420
Y6901612	19	12	3/4"	1"	56	118	66	47,6	32,92x3,53	420
Y6901216	25	16	1"	3/4"	72	145	67	41,3	24,99x3,53	415
Y6901616	25	16	1"	1"	72	145	72	47,6	32,92x3,53	415
Y6902016	25	16	1"	1 1/4"	72	145	79	54	37,69x3,53	415
Y6902020	31	20	1 1/4"	1 1/4"	91	178	86	54	37,69x3,53	415
Y6902420	31	20	1 1/4"	1 1/2"	91	178	93	63,5	47,22x3,53	415
Y6902424	38	24	1 1/2"	1 1/2"	108	202	100	63,5	47,22x3,53	345
Y6903232	51	32	2"	2"	143	240	131	79,4	56,74x3,53	345

Y645

45° SWEPT ELBOW - SAE J518 FLANGE - 6000 PSI - ONE PIECE BOCHT 45° FLENS SAE J518 - 6000 PSI - UIT 1 STUK

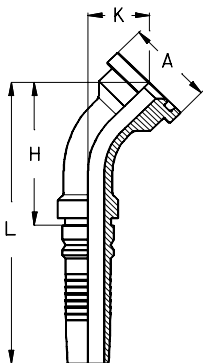

TIEFFE Part.N.	Hose I.D. Ø interno tubo			Flange Flangia	Dimensions (mm)					W. P. (max) bar
	DN	SIZE	Inch		H	L	K	A	O'Ring**	
Y6451212	19	12	3/4"	3/4"	67	129	31	41,3	24,99x3,53	420
Y6451612	19	12	3/4"	1"	71	132	34	47,6	32,92x3,53	420
Y6451216	25	16	1"	3/4"	78	151	31	41,3	24,99x3,53	415
Y6451616	25	16	1"	1"	82	155	35	47,6	32,92x3,53	415
Y6452016	25	16	1"	1 1/4"	87	160	40	54	37,69x3,53	415
Y6452020	31	20	1 1/4"	1 1/4"	100	188	40	54	37,69x3,53	415
Y6452420	31	20	1 1/4"	1 1/2"	105	193	45	63,5	47,22x3,53	415
Y6452424	38	24	1 1/2"	1 1/2"	117	211	46	63,5	47,22x3,53	345
Y6453232	51	32	2"	2"	154	252	60	79,4	56,74x3,53	345

** The "Part.N." do not include O'Ring.

** IL "Part.N." non comprende O'Ring.

YC

STRAIGHT "SUPERCAT" FLANGE - ONE PIECE RECHTE FLENS "SUPERCAT" - UIT 1 STUK

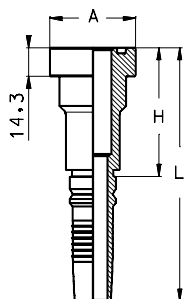

TIEFFE Part.N.	Hose I.D. Ø interno tubo			Flange Flangia	Dimensions (mm)					W. P. (max) bar
	DN	SIZE	Inch		H	L	A	O'Ring**		
YC1212	19	12	3/4"	3/4"	64	126	41,3	24,99x3,53	420	
YC1612	19	12	3/4"	1"	65	127	47,6	32,92x3,53	420	
YC1616	25	16	1"	1"	69	142	47,6	32,92x3,53	415	
YC2016	25	16	1"	1 1/4"	72	145	54	37,69x3,53	415	
YC2020	31	20	1 1/4"	1 1/4"	73	161	54	37,69x3,53	415	
YC2420	31	20	1 1/4"	1 1/2"	80	168	63,5	47,22x3,53	415	
YC2424	38	24	1 1/2"	1 1/2"	81	175	63,5	47,22x3,53	345	

YC90

90° "SUPERCAT" FLANGE - ONE PIECE FLENS 90° "SUPERCAT" - UIT 1 STUK

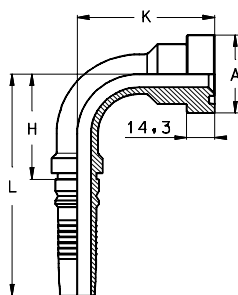

TIEFFE Part.N.	Hose I.D. Ø interno tubo			Flange Flangia	Dimensions (mm)					W. P. (max) bar
	DN	SIZE	Inch		H	L	K	A	O'Ring**	
YC901212	19	12	3/4"	3/4"	55	117	70	41,3	24,99x3,53	420
YC901612	19	12	3/4"	1"	55	117	73	47,6	32,92x3,53	420
YC901616	25	16	1"	1"	71	144	79	47,6	32,92x3,53	415
YC902016	25	16	1"	1 1/4"	71	144	82	54	37,69x3,53	415
YC902020	31	20	1 1/4"	1 1/4"	90	177	89	54	37,69x3,53	415
YC902420	31	20	1 1/4"	1 1/2"	90	177	97	63,5	47,22x3,53	415
YC902424	38	24	1 1/2"	1 1/2"	107	201	105	63,5	47,22x3,53	345

YC45

45° "SUPERCAT" FLANGE - ONE PIECE FLENS 45° "SUPERCAT" - UIT 1 STUK

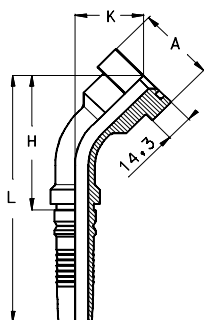

TIEFFE Part.N.	Hose I.D. Ø interno tubo			Flange Flangia	Dimensions (mm)					W. P. (max) bar
	DN	SIZE	Inch		H	L	K	A	O'Ring**	
YC451212	19	12	3/4"	3/4"	73	135	37	41,3	24,99x3,53	420
YC451612	19	12	3/4"	1"	76	137	39	47,6	32,92x3,53	420
YC451616	25	16	1"	1"	87	160	40	47,6	32,92x3,53	415
YC452016	25	16	1"	1 1/4"	88	161	41	54	37,69x3,53	415
YC452020	31	20	1 1/4"	1 1/4"	102	189	42	54	37,69x3,53	415
YC452420	31	20	1 1/4"	1 1/2"	108	196	48	63,5	47,22x3,53	415
YC452424	38	24	1 1/2"	1 1/2"	120	214	49	63,5	47,22x3,53	345

** The "Part.N." do not include O'Ring.

** Het "artikel no" is zonder O'Ring.